

ONKYO® SERVICE MANUAL

Direct Drive Highest Fidelity Turntable

CP-700M



INDEX

| Item | Page |
|----------------------------------|------|
| Specifications | 2 |
| Service Adjustment And Procedure | 2 |
| Bottom View | 3 |
| Packing Procedure | 4 |
| Parts List | 6 |
| Circuit Diagram | 7 |

ONKYO®
AUDIO COMPONENT

SPECIFICATIONS

| | | | |
|-----------------------|---|---------------------------|---|
| Type | Manual direct drive turntable with arm lifter | | headshell exchangeable, anti-skating and lateral balancer |
| Turntable | 31 cm aluminum diecast with stroboscope | | Effective arm length: 220 mm |
| | weight: 1.6 kg. | | Overhang: 15 mm |
| Motor | 8 poles 24 slots brushless DC servo motor | Suitable Cartridge Weight | 3 to 15 grams |
| Speed | 33-1/3, 45 rpm. | Power supply rating | 100-120V/220-240V, 50/60Hz |
| | adjustable range: $\pm 2\%$ | Power consumption | 3 W |
| Wow & Flutter | 0.04% | Dimension | 452W x 174H x 374D mm |
| Signal to Noise Ratio | 60 dB | | 17-13/16" W x 6-7/8" H x 14-3/4" D |
| Tonearm | Static balanced pipe arm with | Weight | 10.5 kg. 23.1 lbs. |

Specifications are subject to change without notice for improvement.

SERVICE ADJUSTMENT AND PROCEDURE

1. Power voltage selection

The record player has been set a voltage of 220/240V before shipment.

To change for 100/120V, turn switch to the right position.

To change voltage, detach the fixture plate, adjust switch position and reattach the fixture plate.

The voltage selector switch is located under the turntable.

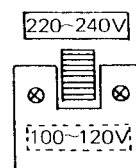

fig. 1

2. Tonearm height

When adjusting the tonearm height, slacken the height adjustment screws at the back of the arm base.

Arrange it in such a way that the arm may be traceable horizontally at all times. (The possible range of adjustment is 8 mm from the lowest to the highest position.)

With the tonearm height adjusted, arrange for the arm rest mount to be level with the arm resting on it.

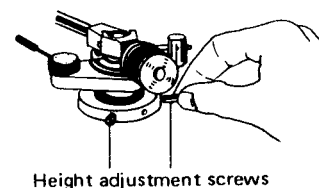

fig. 2

3. The record player does not include the cartridge among its accessories, and it is recommended that a cartridge with weight ranging from 5 to 13 grams is brought into use in the event the attached head shell is utilized. However, needle pressure should be held at a maximum of 3 grams. The head shell weight (inclusive of the finger, screws, nuts and washers) is 7.5 grams. OC - 32 V is a recommended cartridge.

4. The service life of the motor runs 5,000 consecutive hours. There is no need for lubricating oil to be applied to the bearing since it is manufactured of the "oilless" metal.

5. When adjusting the arm lifter height, the 3-mm-thick enamel screw holding the arm and the arm lifter in position should be loosened with a hexagonal wrench.

6. Variable range of the speed control VR attached to the cabinet-top is $\pm 2\%$. The same for the semi-fixed VR fitted on the motor for speed control is $\pm 6\%$. Speed increases as the control VR is turned clockwise while turning the same counterclockwise reduces speed with both.

7. The torque applied in tightening the hexagonal nut at the 4 corners in assembling the cabinet stands at 7 - 9 kgs. Proceed with caution since tightening in excess will result in cushion rubber deformation or will possibly affect howling.

8. The torque applied in tightening the angle in fixing the speed control VR in position, on the other hand, stands at 3 - 4 kgs. Proceed with caution as excessive tightening may cause the screw welded on cover to come off.

PARTS LIST

| PARTS NO. | DESCRIPTION | SPECIFICATIONS | Q'TY | STOCK NO. | REMARKS |
|-----------|-------------------------|-------------------|------|------------|------------------|
| A350 | Cabinet ass'y | | 1 | 28110059 | |
| A350a | Cabinet-Top | | (1) | 28110060 | |
| A350a-2 | Headshell Stand | | (1) | 24509024 | |
| A350b | Cabinet-Side | | (1) | 28110061 | |
| A350b-2 | Badge | | (1) | 28135034 | |
| A350e | Adaptor Rest | | (1) | 24509020A | |
| A350K | Chassis | | (1) | 27100010A | |
| A350n | Label-Voltage | | (1) | 282992 | |
| A359 | Cover | | 1 | 27210041 | |
| A360 | Cover-Speed Selector | | 1 | 27210042 | |
| A361 | Lamp Case | | 1 | 24509021 | |
| | Dust Cover ass'y | | 1 | | |
| A380 | Dust Cover | | (1) | 28165028-2 | |
| A381 | Cushion Rubber | | (2) | 28170001A | |
| A382 | Badge | | (1) | 28135024 | |
| A383 | Hinge ass'y | | 2 | 28180019 | |
| A383a | Hinge | | (2) | 28180020 | |
| A383b | Plate | | (2) | 28180022 | |
| A389 | Shield Plate | | 1 | 27150041 | |
| A394 | Plug-PS | SFÖ-40A3 | 1 | 250227 | |
| A395 | Socket-PS | | 1 | 250226 | |
| A400 | Power Supply Cord | AS-CEE | 1 | 253083 | |
| A401 | Pin Jack | NTM-2PBS-1SPR-E1 | 1 | 25045017 | Out Put Terminal |
| A402 | Conversion Plug | CV-K | 1 | 292063 | |
| A404 | Insulator | | 4 | 280643-2 | |
| A601 | Bottom Board | | 1 | 27170011 | |
| A801 | Knob-Push | | 3 | 28320118 | |
| A802 | Knob-Speed Selector | | 2 | 28320119 | |
| A001 | Bracket A | | 1 | 27130067 | |
| A002 | Bracket B | | 1 | 27130068 | |
| A003 | Slide Switch | S-J0275 | 1 | 250159 | Voltage Selector |
| PL901 | Neon Lamp | NE-2HW | 1 | 211002 | |
| Z001 | Motor | | 1 | 24502018 | |
| Z002 | Turntable | | 1 | 24502019 | |
| Z003 | Tonearm ass'y | | 1 | 24501075 | |
| Z003a | Tonearm | | (1) | 24501086 | |
| Z003b | Counter Weight | | (1) | 24501087 | |
| Z003c | Lateral Weight | | (1) | 24501088 | |
| Z003d | Arm Lifter | | (1) | 24501089 | |
| Z003e | Height Adjustment Screw | | (2) | 24501090 | |
| Z005 | Headshell | | (1) | 24501085 | |
| Z006 | Arm Rest | | 1 | 24501077 | |
| S999 | Power Switch | NPS-112LN4 | 1 | 25035021 | |
| R701, 702 | Resistor-Variable | N16R1KB20 | 2 | 5146002 | Speed Control |
| T901 | Transformer-Power | NPT-592AG | 1 | 250153 | |
| C998 | Capacitor-Ceramic | CK45E500V103P | 1 | 335251039 | |
| C997 | Capacitor-Electrolytic | CE62W50V1000S-R-L | 1 | 3504076 | |
| Z021 | SW-AS | NASW-327 | 1 | 16918527 | |
| Z022 | PS-AS | NAPS-322a | 1 | 16915522A | |
| Z023 | PS-AS | NAPS-221a | 1 | 16918521A | |

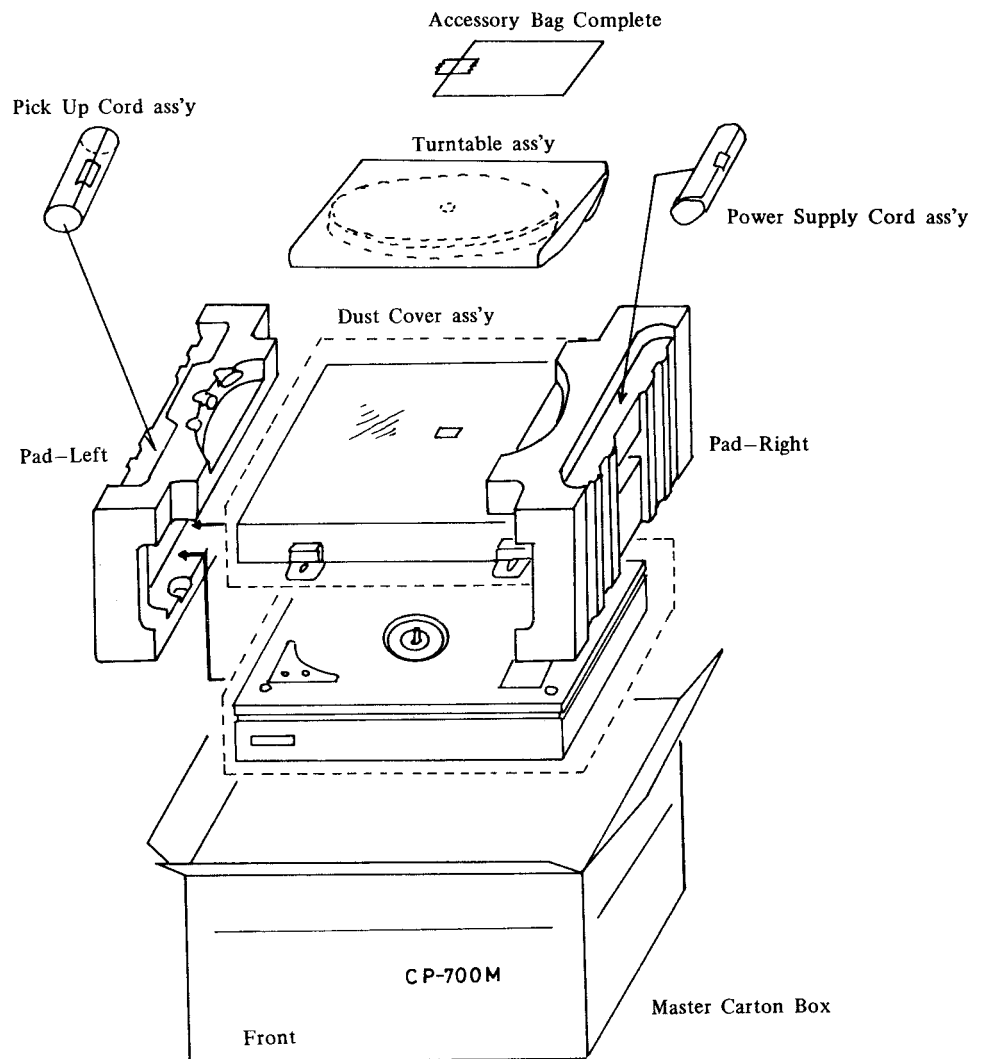
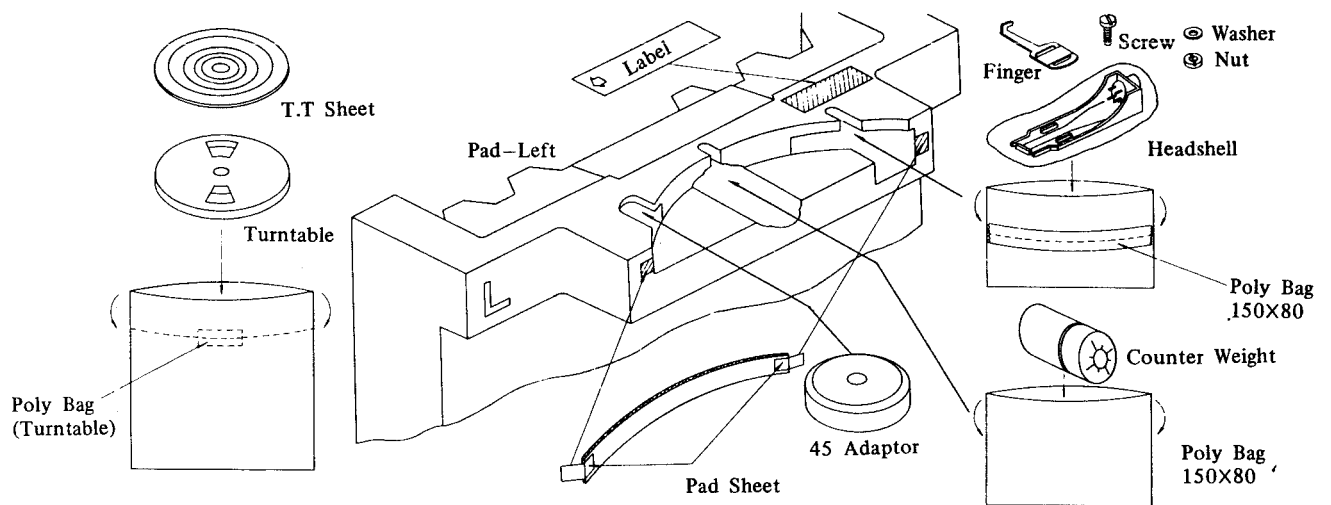

PACKING PROCEDURE

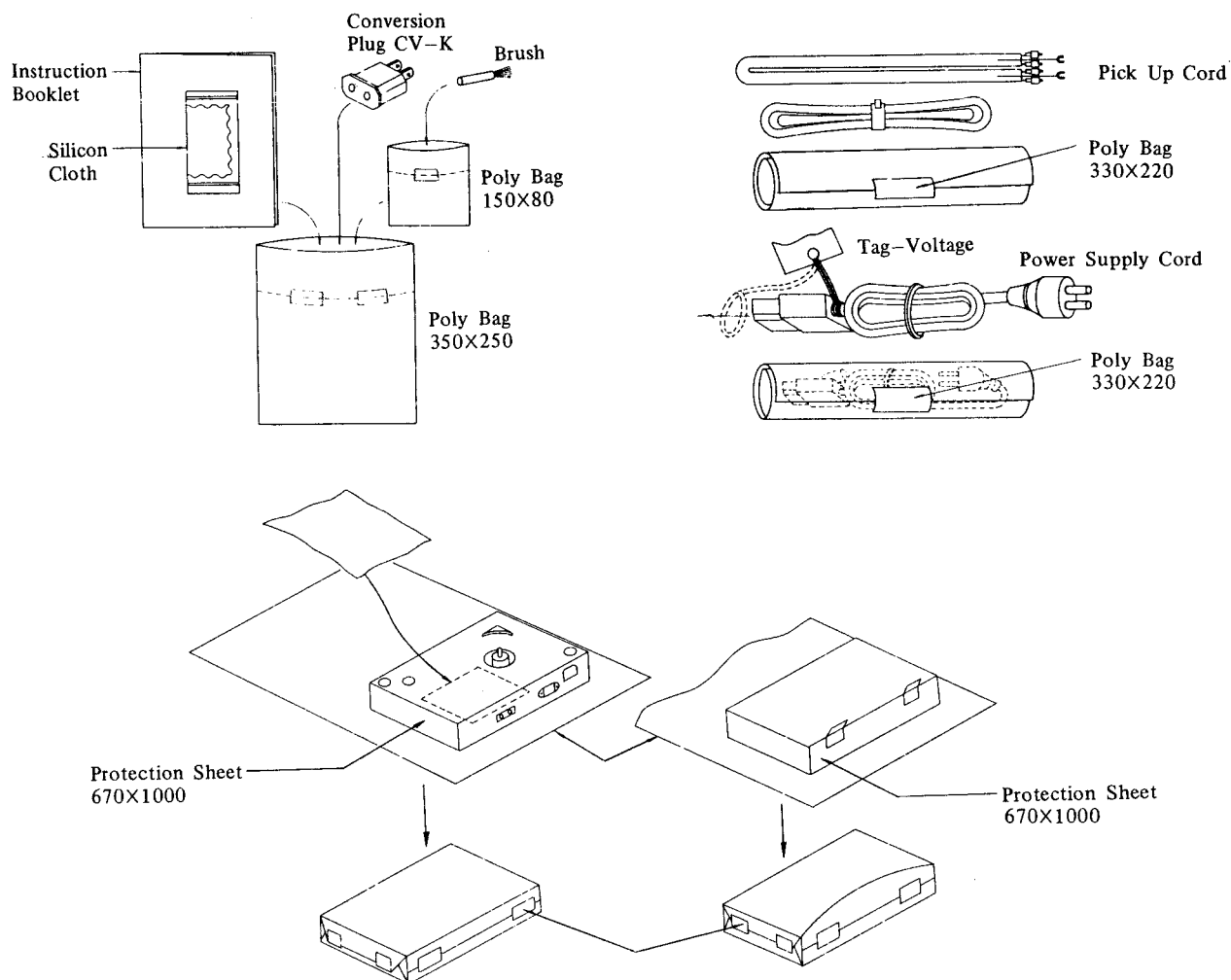

| PARTS NO. | DESCRIPTION | SPECIFICATIONS | Q'TY | STOCK NO. | REMARKS |
|-----------|---------------------|-----------------------|------|---------------------|---|
| A901 | Rating Plate | | 1 | 29360062 | (Turntable) Power Supply Cord Pick Up Cord Headshell, Brush Counter Weight Instruction Booklet |
| A904 | Instruction Booklet | | 1 | 29340124 | |
| A906 | Tag-Voltage | | 1 | 293268 | |
| A910 | Poly Bag | | 1 | 290312 | |
| A911 | Silicon Cloth | | 1 | 292017 | |
| A914 | Poly Bag | 330X220 | 2 | 29100005 | |
| A915 | Poly Bag | 150X80 | 3 | 29100002 | |
| A916 | Poly Bag | 350X250 | 1 | 29100006 | |
| A917 | 45 Adaptor | | 1 | 292023 | |
| A918 | T.T Sheet | | 1 | 27300024 | |
| A920 | Pick Up Cord | | 1 | 24505014 | |
| A921 | Brush | | 1 | 292059 | |
| A851 | Master Carton Box | | 1 | 29050047 | |
| A852 | Pad-Right | | 1 | 29090106 | |
| A853 | Pad-Left | | 1 | 29090107 | |
| A854 | Protection Sheet | 670X1000 | 2 | 29095016 | |
| A855 | Pad Sheet | | 1 | 27300039 | |
| A857 | Label | | 1 | 29360059 | |
| | ((DEUTSCHLAND)) | | | | |
| | Power Supply Cord | AS-VDE or AS-VDE-1 | 1 | 253085 or 253088 | |
| | Instruction Booklet | | 1 | 29340144 | |
| | Warranty Card | | 1 | 29365001 | |

9. The dust cover, which is shock-proof, is fitted on the bottom board of the cabinet. This can be pulled out readily when removing as it is of vertical plug-in type.

10. Overhang Adjustment

“Overhang” is the distance that the stylus tip should protrude over the center of the turntable shaft when the arm is moved exactly over the shaft. See fig. 3. The proper overhang is 15 mm (approx. 5/8 of an inch). It can be adjusted by somewhat loosening the cartridge mounting screws and moving the cartridge in the head shell. Be sure, however, not to fasten the cartridge in a slanted position.

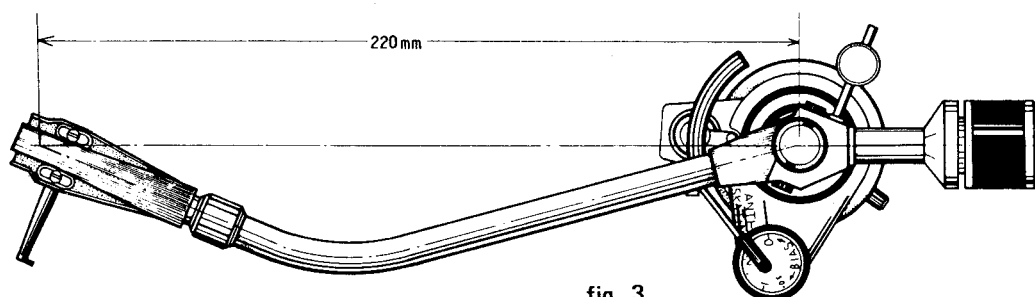
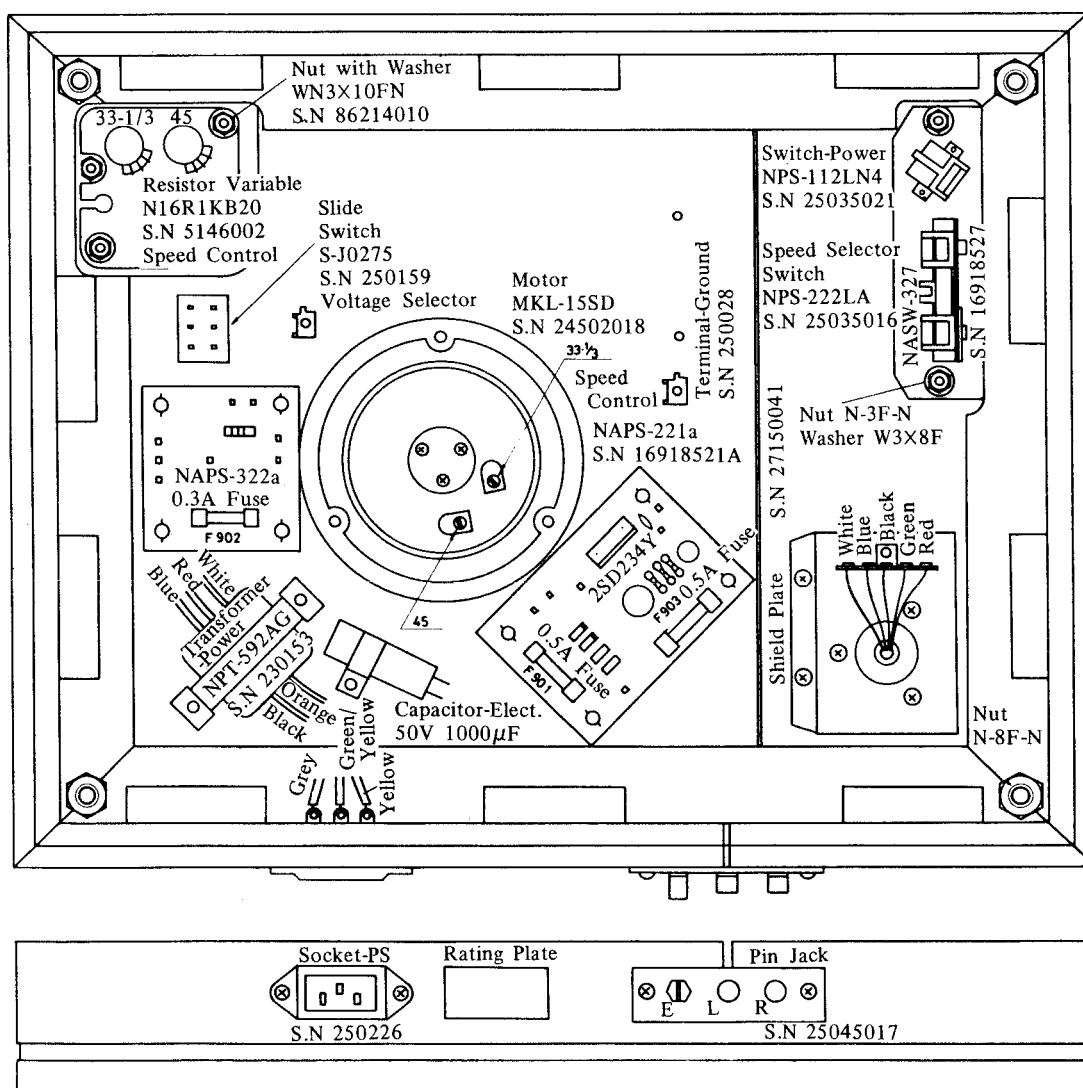

fig. 3

BOTTOM VIEW



-7-



Downloaded from www.linephaze.com

Downloaded from www.linephaze.com