

THE
GRYPHON



Downloaded from www.linephaze.com

- Find specs, manuals and used listings across thousands of audio products.

THE GRYPHON



Gryphon EOS 5 **Reference Loudspeaker**

Owner's Manual

Rev. 1.0

Downloaded from www.linephaze.com

- Find specs, manuals and used listings across thousands of audio products.

Downloaded from www.linephaze.com

- Find specs, manuals and used listings across thousands of audio products.

Table of Contents

Creating an Icon	7	Setting up the EOS 5	17
Gryphon's Founding Father	8	Choice of Feet	17
Foundation for Excellence: Gryphon Design Fundamentals	8	Listening Position	22
Timeless Beauty	11	Rear-wall distance	20
Bespoke Manufacture	11	Sidewall distance	22
The Gryphon EOS 5	13	Toe-In	24
Features	14	Rake/Tilt	27
Choice of Cables	16	Hight Adjustment	28
		Specifications	30
		Unpacking.....	32
		Warranty & Support.....	34
		Notes	35



The Gryphon Name

The Gryphon name and symbol are the ideal images for our brand,
inspired by Greek mythology—part eagle, part lion—
the perfect union of grace and agility with power and authority.

Gryphon Audio Designs is quite simply
*“The ultimate choice for the enthusiast who wants the sound with no frills other than the
luxury imparted by the fit, feel and finish.”*
(Hi-Fi News & Record Review magazine, UK)

The Gryphon Genetic Code

The Gryphon DNA has been defined by one writer as:

*“A code of perfectionism, the likes of which I’ve only ever seen at the Bugatti atelier in Alsace or at the great watch
houses in Switzerland. It is the result of not accepting the notion of compromise, on any level.”*
(Ken Kessler, audio critic)

At the very core of this genetic code lies what one critic described as Rasmussen’s
“Subversion of traditional hi-fi styling.”
(HiFi Choice magazine, UK)

with designs *“...so clean and simple, yet elaborate.”*
(Positivefeedback.com, USA)

Similar sentiments echo around the world

Creating an Icon



In virtually every category of consumer goods—fashion, automobiles, furniture, wine, watches, etc.—there exists a revered top tier of luxury and excellence, a small yet celebrated, High End segment populated by innovative designers who pursue perfection with little concern for production economies, practicality or cost.

The essence of these “Aspirational Brands” is consistent: aesthetic beauty, advanced technologies, superior performance and extravagant build quality combine to achieve unsurpassed levels of fit, feel, finish and function; as a result, all of these offerings represent the very best that can be achieved, created for the discerning few who can appreciate and afford them.

While many of these marques are familiar, others are known only to a limited group of cognoscenti. Curiously, High End audio systems remain a mystery to many connoisseurs. This lack of awareness can be explained by products whose unimpressive aesthetics or awkward functionality clash with the refined sensibilities of potential owners.

At Gryphon, functionality has been optimized through intuitive user interfaces on high-visibility, multi-mode touch displays, with most functions repeated on dedicated remote handsets for optimum user-friendliness.

As for aesthetics, the sculptural beauty of Gryphon components, combined with their extraordinary fit and finish, elevates fine audio componentry to objects of worship which are right at home in the finest domestic spaces.

For the uninitiated, who mistakenly assume that they are unable to distinguish finer musical nuances as reproduced by High End audio systems, even the briefest audition proves that most individuals can discern and appreciate the “You-Are-There” realism offered by fine High End home entertainment equipment. Rest assured: if you’re passionate about music, the illusion that the listener can be transported to the performance venue is both apparent and addictive.

The fortunate few with the means to acquire the ultimate in-home entertainment experience owe it to themselves to experience the pleasure which a Gryphon Audio System delivers.



Gryphon's Founding Father

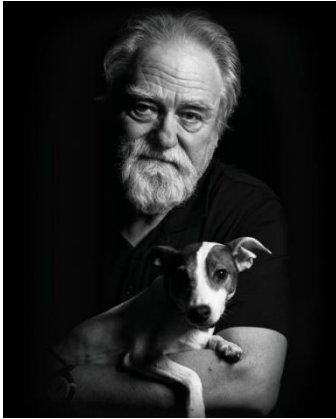

After 33 years at Gryphon Audio Designs, Flemming Erik Rasmussen recently retired from the company he founded in 1985 to devote himself to his favourite pastimes including his first love, painting.

Rasmussen's audio career was purely serendipitous, transitioning from fine arts to fabric design to High End Audio Distribution and finally, to the creation of The Gryphon brand as an expression of his audio philosophies. Gryphon's first product, the now legendary Gryphon Head Amp, was developed for Flemming's personal use. Almost immediately, demand generated by rave reviews and "Audiophile Buzz" led to the formal establishment of Gryphon Audio Designs.

Rasmussen's background in fine arts and industrial design has infused every Gryphon product with distinctive, luxuriant styling. His elegant, uniquely Scandinavian black-on-black designs defined the "Nordic Noir" aesthetic long before TV crime dramas appropriated the term. His legacy is palpable in the visual aesthetic of current Gryphon chassis, as well as the ethos of quality and performance embodied in all Gryphon products. His selection of Tom Moeller as Chief Electronics Designer set Gryphon on the path to the design and performance supremacy that it occupies to the present day.

Although Rasmussen's formal involvement with Gryphon ended with the chassis design of the Diablo 333, the principles upon which he founded the company continue to the present day and inspire every Gryphon Product.

Foundation for Excellence: Gryphon Design Fundamentals

More than ever before, our commitment to absolute sonic and aesthetic perfection, regardless of price or commercial pressures, are the cornerstone of every Gryphon product. For more than twenty years, circuit design of all Gryphon Audio components has been overseen by Chief Electronics Designer Tom Moeller. The countless accolades, awards and critical acclaim that have distinguished Gryphon for nearly 40 years are the result of a commitment to excellence shared by every Gryphon employee.

Great Performers Deserve Ultimate Performance

Thanks to state-of-the-art technical equipment and some of the finest minds in audio engineering, the Gryphon brand continues to define the highest standards of subjective and technical excellence. Common to all Gryphon components, these design fundamentals have proven essential for achieving ultimate audio realism/performance.

Utilized in every Gryphon product, our Dual Mono Signal Paths eliminate any possibility of crosstalk or other inter-channel interference and provides infinite channel separation, the result of which is unsurpassed ability to convey space, focus, depth and transparency. Spatial recreation, dimensionality and image focus are limited only by the information contained on the recording.

Because the electrical power in your home can fluctuate wildly in terms of voltage, noise and distortion, Gryphon incorporates Heavily Regulated Multi-stage Power Supplies that act as effective mains conditioning filters. Displays and control circuits are fed by independent power supplies to isolate any digital noise artifacts and effectively prevent extraneous noise from contaminating the analogue signal path.

While the printed circuit boards in most audio products utilize conductor traces a mere 35 μm thick, Gryphon employs 70 μm or Thicker PC traces of the highest purity copper. (The conductor traces developed for Apex are an astounding 105 μm thick!)

Beginning with our very first product, "The Head Amp," all Gryphon products have featured extremely Wide Frequency Bandwidth, because the ability to accurately reproduce infra-sonic and ultra-sonic frequencies ensures linear phase response across the audible frequency range, for superior tonality, detail resolution and spatial performance. The implementation of circuits with wideband frequency response is a painstaking, iterative endeavour in which physical component layout and grounding pattern of the circuit boards are crucial to the attainment of superior sonic performance with no loss of inherent electrical stability. Wideband frequency response ensures high slew rate—essential to the realistic recreation of the ultra-fast transients which routinely occur in live music—and is crucial in recreating the entire harmonic envelope of acoustic instruments.



All Gryphon designs are realized with none or an absolute minimum of negative feedback which, when present in large amounts, increases transient intermodulation distortion. With the exception of the Antileon series of power amplifiers (which utilize a minimum amount of

negative global feedback) all Gryphon amplifiers are designed with Zero Negative Global Feedback.

Gryphon's research into the detrimental effects of magnetically induced distorted (MID) has led to the Elimination of Magnetizable Materials wherever possible. To eliminate the effects of stray magnetic fields, non-magnetic materials are employed throughout every Gryphon product, with the unavoidable exception of the transformer shields.

The mechanical design and assembly methods of Gryphon chassis are carefully calculated to ensure Minimal Chassis Resonance, either through the use of high component mass, mechanical grounding or component decoupling. Vibration-sensitive parts, capacitors in particular, are thus guaranteed a non-resonant environment which, in turn, provides a solid foundation for optimal electrical performance.

Gryphon's Artistically Wrought, Massive Chassis offer a vibration-proof environment for the sensitive electronics inside and provide crucial shielding from a polluted world of low- and high-frequency radio waves, power-line radiation and other electrical interference. Our obsessive attention to such issues enables the relaxing, open and transparent Gryphon sound.

Unique, Non-intrusive Protection Circuitry offers reliable, fuss-free component protection without compromising signal purity or signal path simplicity. Ground paths have been carefully laid out in order to achieve superior sonic performance with no loss of stability. Component layouts are chosen to ensure the shortest conceivable signal paths.

In the interest of ultimate fidelity and signal purity, tone controls, balance controls and other superfluous circuitry have been banished from the signal paths of all Gryphon components.

Exhaustive investigation precedes the selection of every part and many Bespoke, Proprietary Components are custom-built exclusively for Gryphon. And because what is left out is just as important as what goes in, an absolute Minimum of Internal Wiring is utilized.

By devoting obsessive attention to each aspect of the circuit and fully understanding the purpose and behaviour of every single part of the whole, our designers can optimize performance in each section before moving on to the next step. This ensures simplicity, a short signal path and a unity of purpose towards a single, well-defined goal: musical purity.

Timeless Beauty, Aesthetic Perfection

The pride of owning Ultra-Luxe audio systems should be apparent *before* the system is turned-on; for this reason, Gryphon products have always offered sculpturally beautiful design, exquisite control “Feel” and ultimate user-friendliness to complement their standards-setting audio performance. In every Gryphon product, form follows function in a unique synthesis of aesthetics and operational ease which proceed organically from the audio circuit design. Gryphon components combine cutting-edge technology and ageless industrial design executed with the best of artisanal handcraftsmanship, all in the service of music and to the delight of our fortunate owners. The peerless finish, build quality, ergonomics and pride of ownership that contribute to the Gryphon Product Concept can only be fully understood and appreciated through hands-on experience with our products.

High End audio systems don't exist in a vacuum: they reside in the finest domestic interiors outfitted with luxury accoutrements and decorated with a high sense of style. Gryphon produces aspirational components whose extraordinary performance is complemented by ravishing sculptural beauty. No expense has been—or every will be—spared in making every Gryphon component a source of pride of ownership, deserving of a place of honour in the finest homes.

Bespoke Manufacture for Heirloom Build Quality

At our laboratories and manufacturing facilities in Denmark, we maintain full control over every aspect of development and production, and our team members follow each Gryphon component from initial concept, through early prototype, to final quality control. Printed circuit boards are assembled by a supplier of precision military and medical equipment employing the highest standards of quality control and pre-inspection of components and sub-assemblies. Chassis parts are manufactured by specialists chosen solely for their outstanding quality of workmanship. In every aspect of every Gryphon product, the same stringent standards of excellence apply. Each unit is individually tested and then, after a 48-hour burn-in sequence, each product again undergoes both electronic and audio performance testing, ensuring generations of flawless performance.

The System of a Lifetime

Gryphon collectors will upgrade as new models become available: we welcome this and are grateful for their loyalty. On the other hand, there is a large and devoted group of music lovers who choose Gryphon because they consider their purchase to be a once-in-a-lifetime investment because every component we make is Best-in-Class and because they rightfully



expect a lifetime of blissful, trouble-free operation. It is this mandate to deliver heirloom build quality that guides the development of every Gryphon component that has ever been made and that ever will be made. Generational Sustainability—the ability of a product to deliver musical pleasure for an unlimited lifespan—is a fundamental principle of Gryphon Product Development. The overwhelming majority of all Gryphon products are still in daily use. Just as the finest Swiss Watches and Exotic Cars are destined to be handed down from one generation to the next, every product that has ever carried the Gryphon name has been purpose-engineered to stand the test of time, to be cherished as a source of pride and passed along to one's fortunate heirs. In this, Gryphon is the antithesis of obsolescence and therefore unique in the world of consumer electronics.

Another distinction of the Gryphon Design Philosophy is that no component or circuit changes affecting the performance are made during the production run of any Gryphon product. (In those rare cases where a parts substitution is required, we change the model name as, for example, we introduced our Scorpio S CD Player when the DA-Converter ICs used in the original Scorpio was no longer available.) This unit-to-unit consistency is remarkable for consumer electronics products and is extremely difficult to achieve; however, it is the only way to assure long lifespan, long-term maintainability and high resale value.



Downloaded from www.linephaze.com

- Find specs, manuals and used listings across thousands of audio products.

The Gryphon EOS 5 Speaker System

Limitless Performance, Distilled

For nearly 40 years, Gryphon has been world-renowned for State-of-the-Art HiFi creations that redefine the limits of performance...and size. In the realm of loudspeakers, our Kodo and Trident II systems deliver limitless sonic capabilities without regard for commercial constraints. By contrast, the new Gryphon EOS 5 approaches the potential of our Major Statement offerings in a compact, room-friendly package engineered to excel in virtually any domestic environment.

Gryphon's new EOS-series is the brainchild of the Gryphon Design Team, whose work for EOS reveals innovative solutions for achieving big speaker sound from compact enclosures. First among these is EOS' unique "Stealth" cabinet, whose purpose-engineered front baffle enables the drivers to yield smooth dispersion and uniform energy output, as well as a more stable and dimensional soundstage.

EOS' Stealth exterior has been sculpted to function as an efficient diffusor of standing waves—a great advantage in small spaces—while the interior has been critically shaped to eliminate standing waves and cabinet resonances. Gryphon's proprietary "Line porting" technology, a new way of directing the back wave of the midrange and woofers towards the ports, ensures a perfect path for low frequencies to exit the enclosure while providing efficient damping of frequencies above the 60-80 Hz region. The result is shockingly fast and clean bass reproduction, free of distracting upper-frequency artifacts.

EOS-series offer uncompromising parts and build quality. Our proprietary driver cones feature Thin-ply Carbon Fiber diaphragms manufactured to our specifications by the world's leading producer of Formula 1 components. EOS' tweeters—also proprietary—utilize Beryllium domes and resonance-free rear chambers for enhanced dynamics and extended response. Hand-assembled from the finest components, our PCS (Progressive Curved Slope) crossover design maximizes power handling and ensures a seamless transition between drivers. EOS-series loudspeakers present a friendly load for virtually all high-quality power amplifiers.

Those audio connoisseurs whose quest for the best is tempered by space considerations have found their icon: EOS 5 by Gryphon.



Features

Gryphon EOS 5 embodies new and unprecedented engineering solutions to achieve desirable but seemingly contradictory design goals: compact and placement-friendly yet possessed of full-frequency-range performance, highly efficient yet capable of massive power handling and staggering volume output, liquid and fatigue-free yet ruthlessly revealing of recordings and associated equipment, EOS 5 is the ultimate speaker when space is the only limitation.

Building upon technologies developed for Gryphon's revolutionary EOS 2, Gryphon engineers accomplished an even more challenging task: developing a state-of-the-art reference loudspeaker that embodied the ethos and design aesthetic of its smaller sibling. Standing just 1.3 meters tall, EOS 5 delivers Full Frequency Range performance (20-40,000 Hz, +2 dB) and shattering dynamic capability in a compact, attractive package designed for extreme placement versatility and room-friendliness. Achieving this enormous performance envelope in a small package required technologies which did not previously exist. All four drivers are breakthrough designs which are unique to EOS 5: the 6.5" (165mm) Midrange and dual 9.5" Woofers utilize the TPCD™ (Thin-Ply Carbon Fiber Diaphragm) cone construction and Gryphon's proprietary Impulse Optimizer Rings: performance advancements which first appeared in EOS 2. Impulse Optimizer rings are positioned directly behind the voice coils, thereby strengthening the mechanical bond between cone and voice coil for virtually perfect impulse reproduction and "Pure Pistonic Behavior" well beyond each driver's designated reproduction range.

A smaller (1.14"/29mm) Beryllium Dome Tweeter has been purpose-engineered to complement EOS 5's higher mid-treble crossover point while the 6.5" Midrange cone has been optimized to its frequency range. Costly neodymium magnet assemblies eliminate dynamic driver compression and are specified for all four drivers.

Obsessive attention has been paid to maintaining linear phase and impulse response across the entire frequency spectrum, contributing to the EOS 5's seamless, transparent sound. Hand-assembled from the finest electrical components, Gryphon's PCS (Progressive Curved Slope) crossover maximizes power handling and ensures the smoothest possible transition between drivers. Engineered to present an easy amplifier load, 90 dB sensitivity is coupled with a 4 Ohm nominal, 2.9 Ohm minimum impedance.

EOS 5 shares the faceted, jewel-like cabinet aesthetic created for its smaller sibling. This critically-shaped "Stealth" enclosure ensures coherent response and dispersion of the four

drivers and has the secondary function of diffusing in-room standing waves, which helps the speaker “Disappear” within the listening space. Internally, a new Line-Dampened Porting System offers a unique solution to smoothing airflow in this larger, wider-bandwidth loudspeaker. Like EOS 2, the new EOS 5 benefits from design flourishes which enhance placement versatility across a wide range of listening environments. Once again, Gryphon’s custom-manufactured, adjustable spikes are equipped with removeable, integrated dampers to provide the most stable speaker positioning on any flooring surface, either with or without carpeting. A quartet of proprietary binding posts—the same found on our Apex Power Amplifier—enable the choice of single- or Bi-wiring. The complex EOS 5 enclosure is locally handcrafted to the same high standards as fine Danish furniture and like all Gryphon loudspeakers, EOS 5’s elegant, stringed front grille combines beauty and driver protection with complete acoustical transparency.

The crossover is the heart of the EOS 5 performance. Its unique technology, handles much more than just separation of the frequencies sent to each driver:

The Progressive Rounded Slope technology creates roll-off slopes that start with a very soft roll-off, ensuring perfect overlap and blending between the drivers. The slopes then become progressively steeper, effectively removing the out-of-band distortion from the drivers.



Normal Crossover Slope
(Linear roll off)



Baum PCS Crossover Slope
(Progressive Curved Slope)

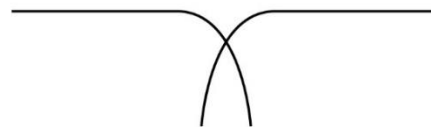

The crossover also aligns the phase response of the four drivers at all frequencies (measured from the listening position) thereby reproducing a life- like soundstage in width, height, and depth.

All drivers are connected in positive polarity and their impulse responses are aligned perfectly. This means that musical timing is reproduced without any smearing or shifts – retaining the original musicality found in the recording.

Choice of Cables

Gryphon's basic philosophy is one of sonic neutrality. We prefer to leave interpretation to the musicians and singers. Therefore, you should not need a cable with a particular "sound" of its own to balance or "equalize" your system. In some circles, unfortunately, cables have become an acceptable equalizer in the High End audio industry.

Trust the advice of your authorized Gryphon dealer in selecting interconnects and loudspeaker cables for your Gryphon equipment and for that matter power cords as well. After all, we are listening to current "converted" into music!

Naturally, Gryphon's own range of interconnects, loudspeaker cables and power cords are used in the development of Gryphon products. Gryphon cables are designed for ultimate neutrality and resolution. They are extremely revealing and will allow the ultimate quality of your Gryphon system or any fine audio components to come through clearly and undiminished.

All Gryphon amplifiers are designed and manufactured with an extreme bandwidth and in some cases the wrong choice of speaker cable can present a technical issue and will create potential problems in the collaboration between the amplifier and the speakers, with the speaker cable as an interactive factor. Gryphon recommends that no speaker cable on a Gryphon amplifier should feature coaxial geometry, active shielding or "Network boxes" that will impose different types of filtration upon the signal. A speaker cable with a coaxial design or with active shielding will in most cases have a much lower bandwidth than the amplifier and therefore the amplifier will be met with a too high capacitive load and might cause oscillation of the amplifier. There is no need to actively add filtration to an analogue amplifier, as it doesn't serve the final reproduction of music.

Gryphon recommends using speaker cables with a low capacitance and a wide bandwidth in order to match the amplifier's bandwidth and output impedance specifications. There is no need to add more "negative" filtration to the system as Gryphon is striving to have the finest level of tonal balance and neutrality. Choose your cables with the highest level of attention to the actual parameters of the cable design (e.g. cable geometry, capacitance, bandwidth, insulation, conductor material and connectors) and aim for low capacitance, low resistance, low inductance and sonic neutrality.

Floor Coupling of EOS 5 - Spikes or Dampers

The process of setting up of your EOS 5 begins with selection of the proper floor coupling "Footer" for your application. EOS 5 benefits from the sophisticated suspension system developed for EOS 2. This system offers a choice of two floor terminations: Spikes or removeable Spike-Dampers. Both are adjustable and enable the speakers to be leveled, a requirement for best performance.

The proper choice of Spikes or Dampers depends upon the nature of the floor in the listening room, as follows:

- Hard Floors Benefit from a "Soft" mechanical connection (Spike Dampers)
- Soft (Carpeted) Floors Require a "Hard" mechanical connection (Spikes)

The provided Spike-dampers are designed to be screwed directly over the spikes. This design ensures a scratch-free set-up process, without the typical challenges with "Spike Protector" coasters not staying in place and potentially damaging surfaces.

Spike Dampers are also highly efficient at eliminating resonances caused by spike ringing.

Pro Tip

When screwing the Spike Dampers in place over the spikes, take special care to properly thread the dampers and avoid damaging the threads.

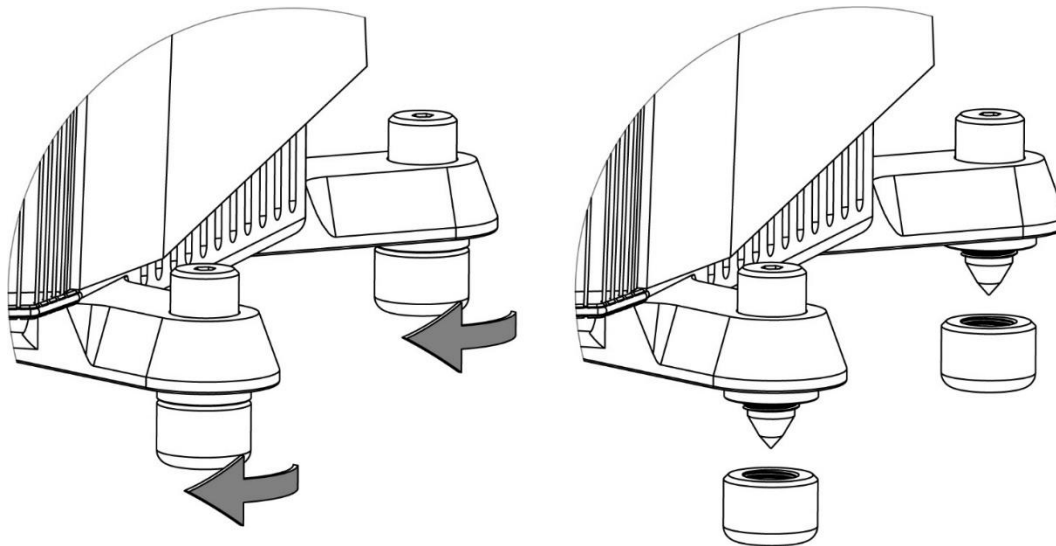

Unique among the components which comprise an audio system, the performance of a loudspeaker is largely determined by the room in which it is placed. In order to realize their ultimate performance potential, considerations of Room Size, Construction and Speaker Placement influenced the design of EOS 2 and EOS 5. Positioning and fine-tuning of EOS 2 and EOS 5 are therefore more rigorous than typical speakers and require more care and precision in setup.

The EOS 5 is designed to be both Phase- and Impulse-linear when placed 3-4 meter (10-13 feet) from the listener. Please take this into account when positioning the EOS 5 in your listening room.

Regardless of overall room size, the optimal listening distance between Speaker and Listener should be between 3-4 meters (10-13 feet) and always positioned in accordance with the geometric proportions of an Equilateral Triangle and a Straight Leg Triangle, as illustrated below:

Example:

In the illustrations above, our room is 5 m / 16 feet wide. We position the speakers 1/5 of the room width. (1 m / 3.3 feet) from each side wall. This leaves our speakers spaced 3 m / 9.4 feet apart (Line **a**), resulting in a range of recommended listening positions between either:

The Equilateral Triangle: 3 m / 9.4 feet away from each speaker (**a=b=c**)

OR

The Straight Leg Triangle: 3 m / 9.4 feet away from the center of line **a** (**a=h**)

Pro Tip

Somewhere in-between these two distances, you will find the optimal position for best soundstage width and depth. Experimentation within this narrow range of placements is essential to find the optimal listening position.

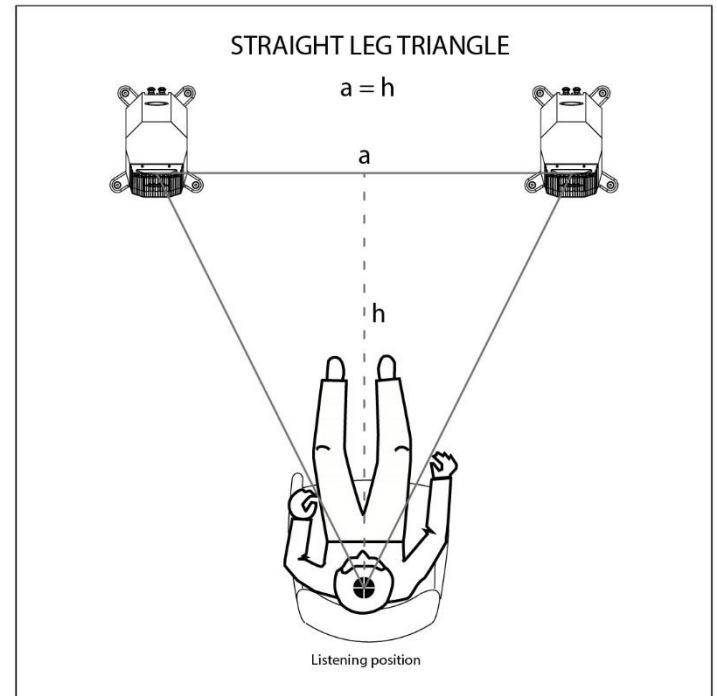
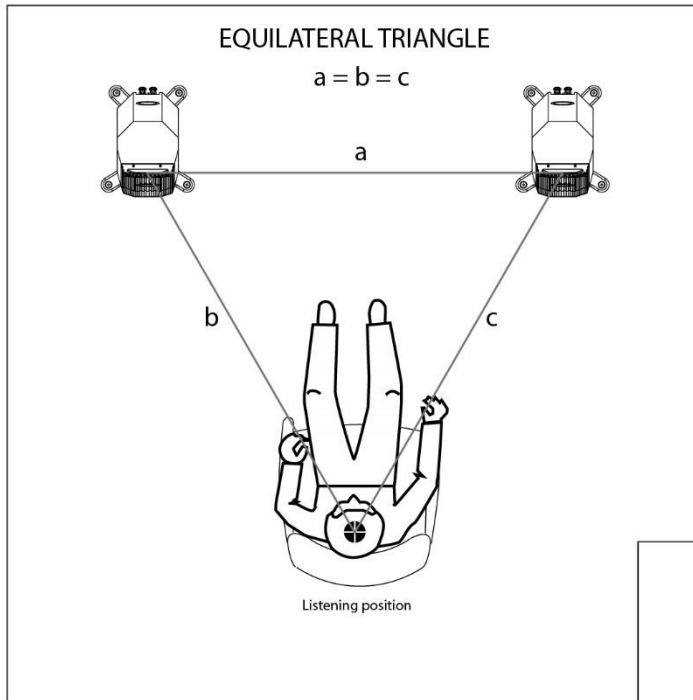

In order to avoid unwanted interference from the rear-port, and to eliminate bass reinforcement, EOS 5 should be positioned a minimum of 1,0 meter from the rear-wall. The optimal distance from the rear wall will support proper low frequency performance without bass reinforcement. As a secondary concern, distance between the speaker and rear wall can affect soundstage depth; fortunately, the positioning that provides the best bass performance usually delivers proper soundstage depth, as well.

Pro Tip

Place both speakers in the approximate locations in which they will reside, pointing towards the listening position. Listening to program material with heavy bass content, move the speakers closer to and farther from the rear wall in small (1 cm/0.5 in) increments until a proper tonal balance is achieved.

3. Rear Wall Distance

Setting Up the EOS

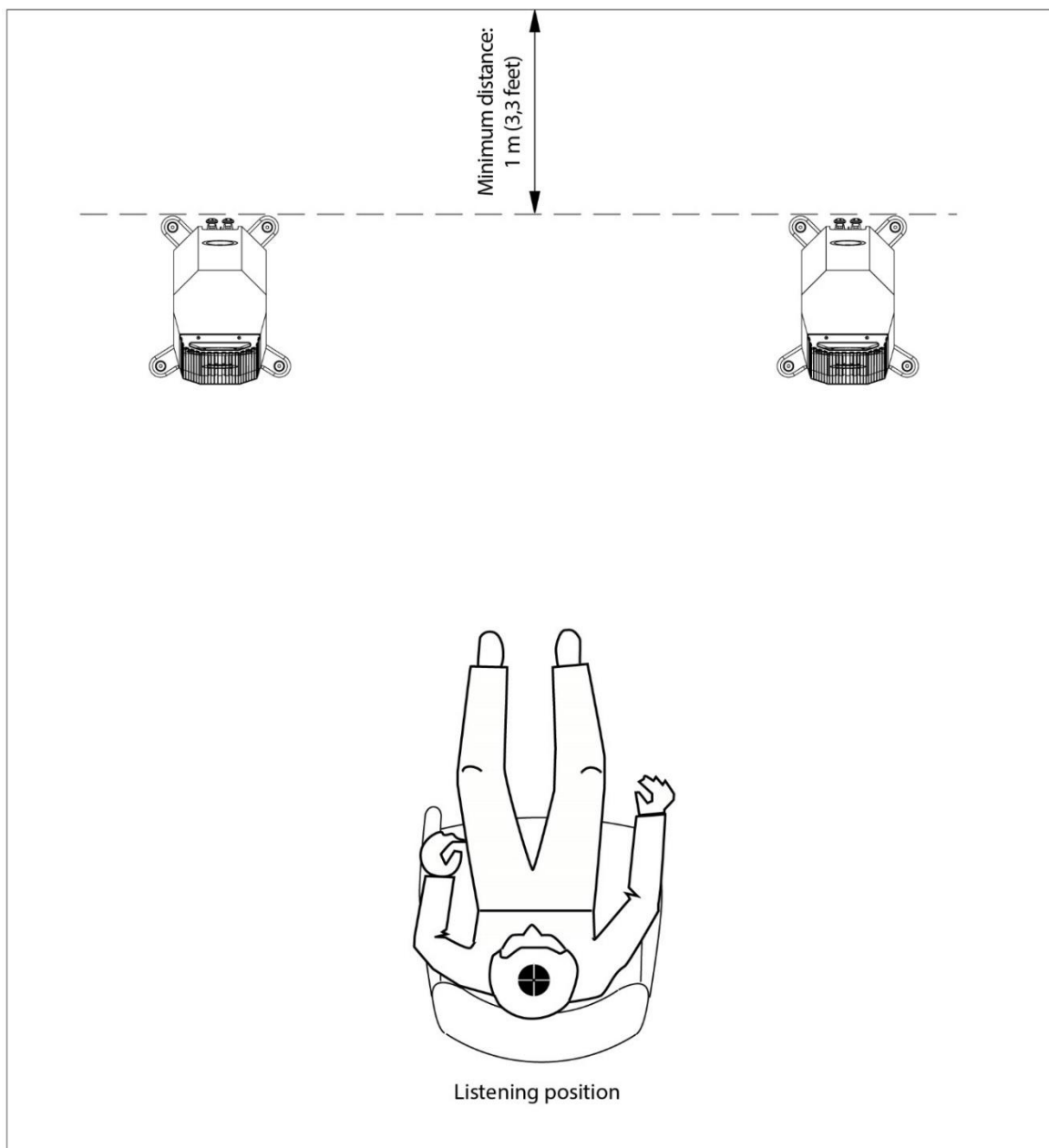

The distance between the EOS 5 and the nearby sidewall affects sound quality in two areas.

- Room nodes (Typically bass notes in the 60-120 Hz region)
- Soundstage (Early side-wall reflections makes the imaging fuzzy)

The solution to these problems is:

- *Placing the speakers at a distance to the sidewall which will make the speakers counteract the room nodes.*
- *Placing the speakers more than 3.3 feet / 1 meter away from the sidewall OR use acoustic treatment to dampen the first reflection.*

Pro Tip

Measure the width of the listening room. Now divide the measured width, with an uneven number. (ex. 5, 7, 9)

The result that comes closest to a position more than 3.3 feet / 1 m away from the sidewall (**A**) is normally the best choice.

If the listening room is very narrow, you will have to position the speakers closer to the sidewalls than recommended to maintain the minimum distance between them. In this case it may help to use more toe-in along with some dampening of the first sidewall reflection.

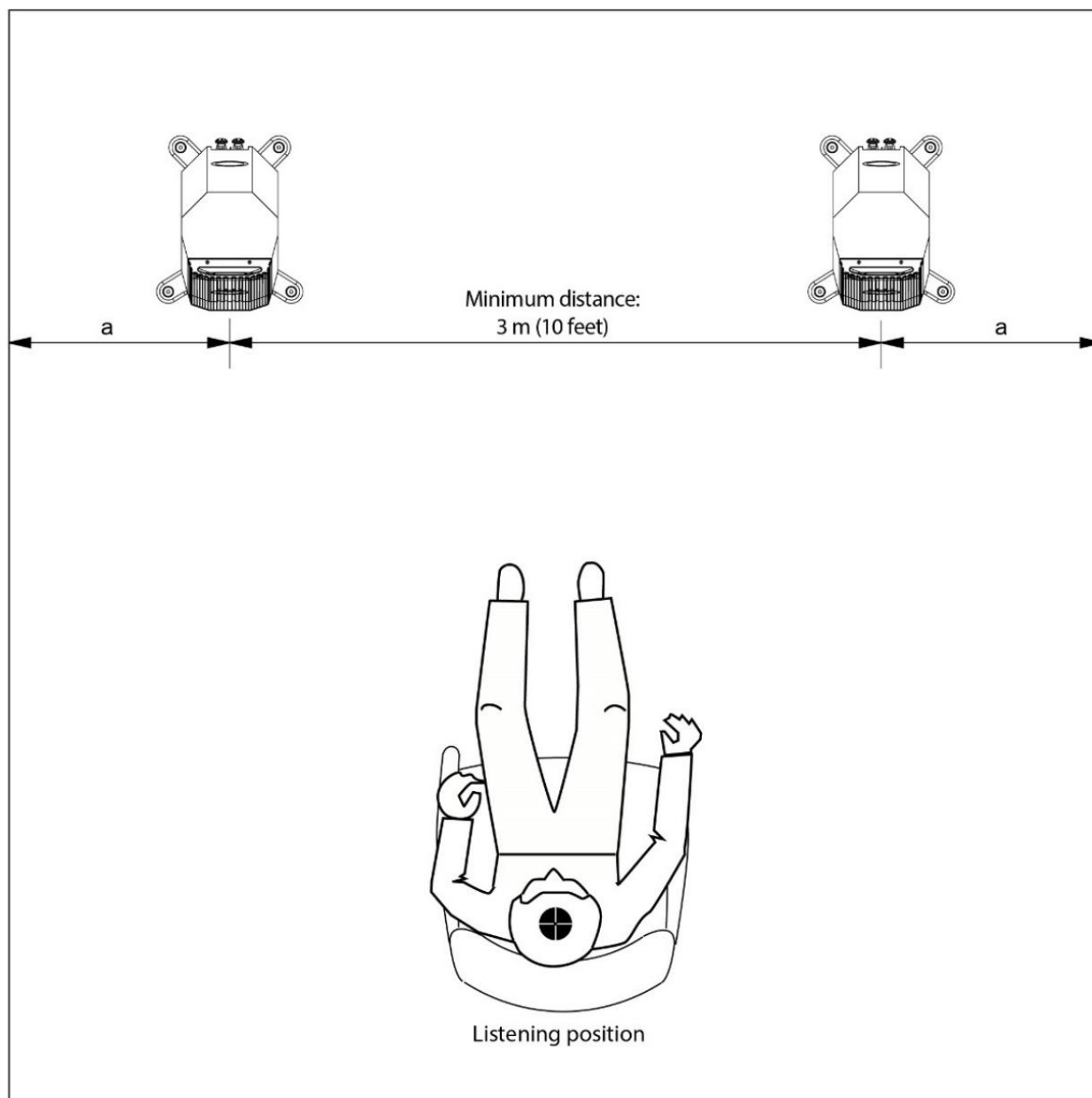

The recommended amount of toe-in needed for the EOS 5 is normally between 5-15 degrees. However, there are situations where a larger amount of toe-in can be necessary. For example:

- Narrow rooms, where the EOS 5 must be positioned less than 1 m / 3.3 feet away from the sidewalls.
- Situations where the listening position must be closer to the speakers than the distance in-between them.

Pro Tip

The ideal amount of toe-in, is achieved when the speakers “disappear” to the greatest extent possible, while maintaining a solid and well-defined center image. Start with recordings of closely miked female vocalists and once a clearly defines center image is achieved, switch to tracks with wide and deep soundstage.

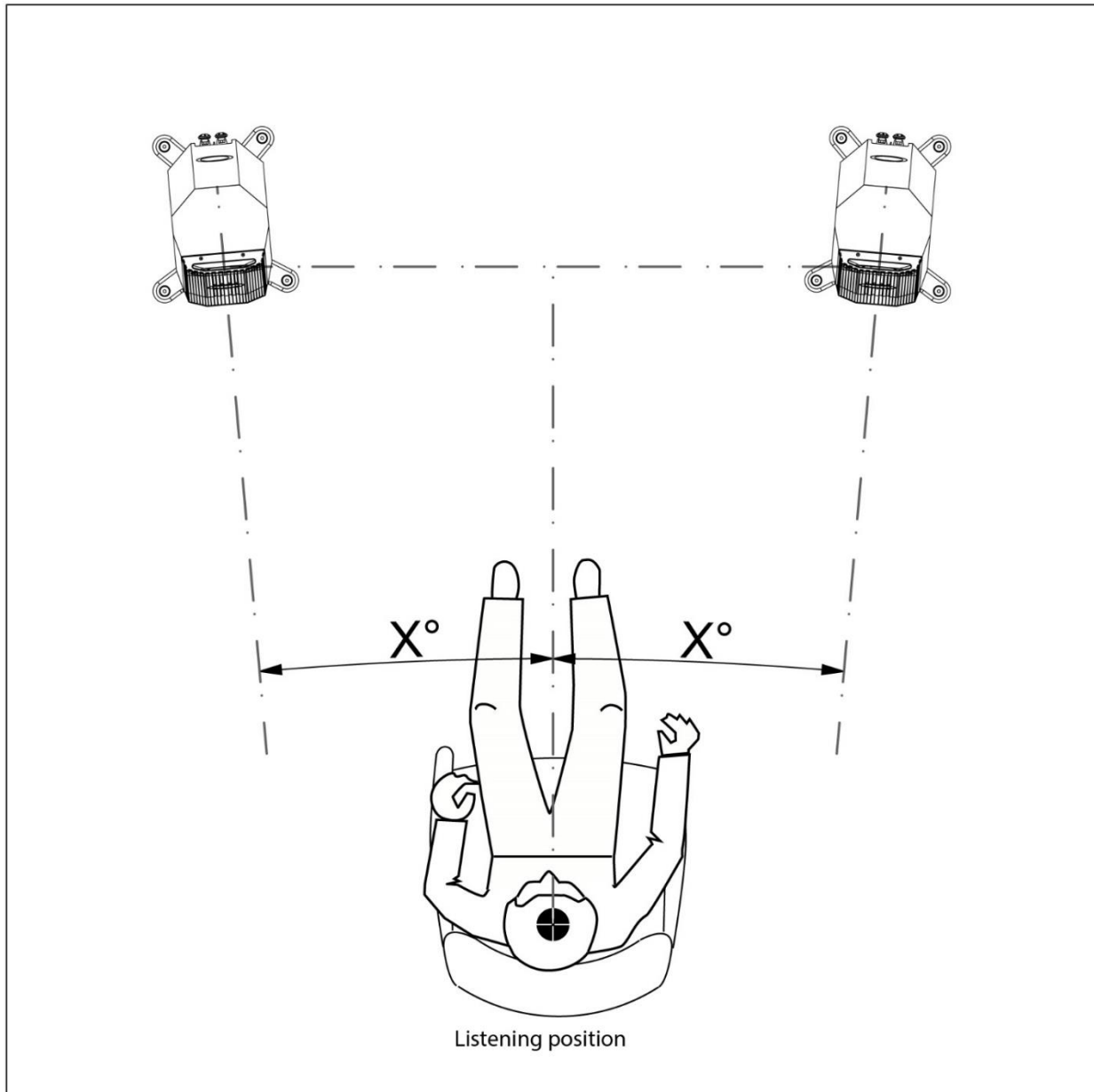

During the design process of the EOS 5, a major goal has been to ensure that both Impulse and Phase response are completely aligned at all frequencies when arriving at the listening position (i.e., your ears).

To adjust the Rake / Tilt of the EOS 5, use the provided Allen-key.

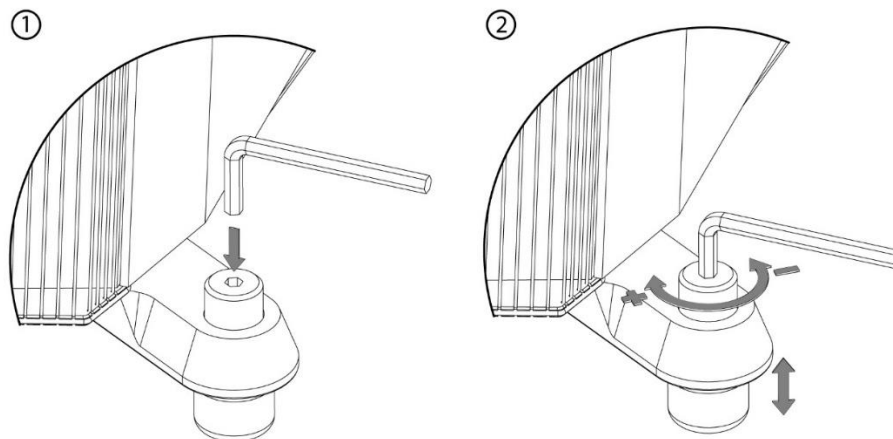

The ideal Rake Angle will depend on Two Factors: 1) the height of the listening position, and 2) the distance between the listening position and the speakers.

Start by adjusting the rake, to make the tweeters point straight at ear height. When ear height is *above* the tweeters, the speaker will be tilted back (i.e., front baffle higher than back panel). For listening position where ear height is below the tweeters, the front baffle will be tilted downward.

The degree of Rake Angle / Tilt will affect the time-alignment between the drivers. This quite easy to hear, so for final adjustments, you will have to use your ears to determine the optimal amount of rake. As described above, proper Rake Angle will yield perfect coherence between the drivers and allow the speakers to sonically "Disappear."

Pro Tip:

If the sound is slightly sharp or harsh: Tilt the EOS 5 *backward* (*Baffle Up*)

If the sound is lacking detail or transient impact: Tilt the EOS 5 more *forward* (*Baffle Down*)

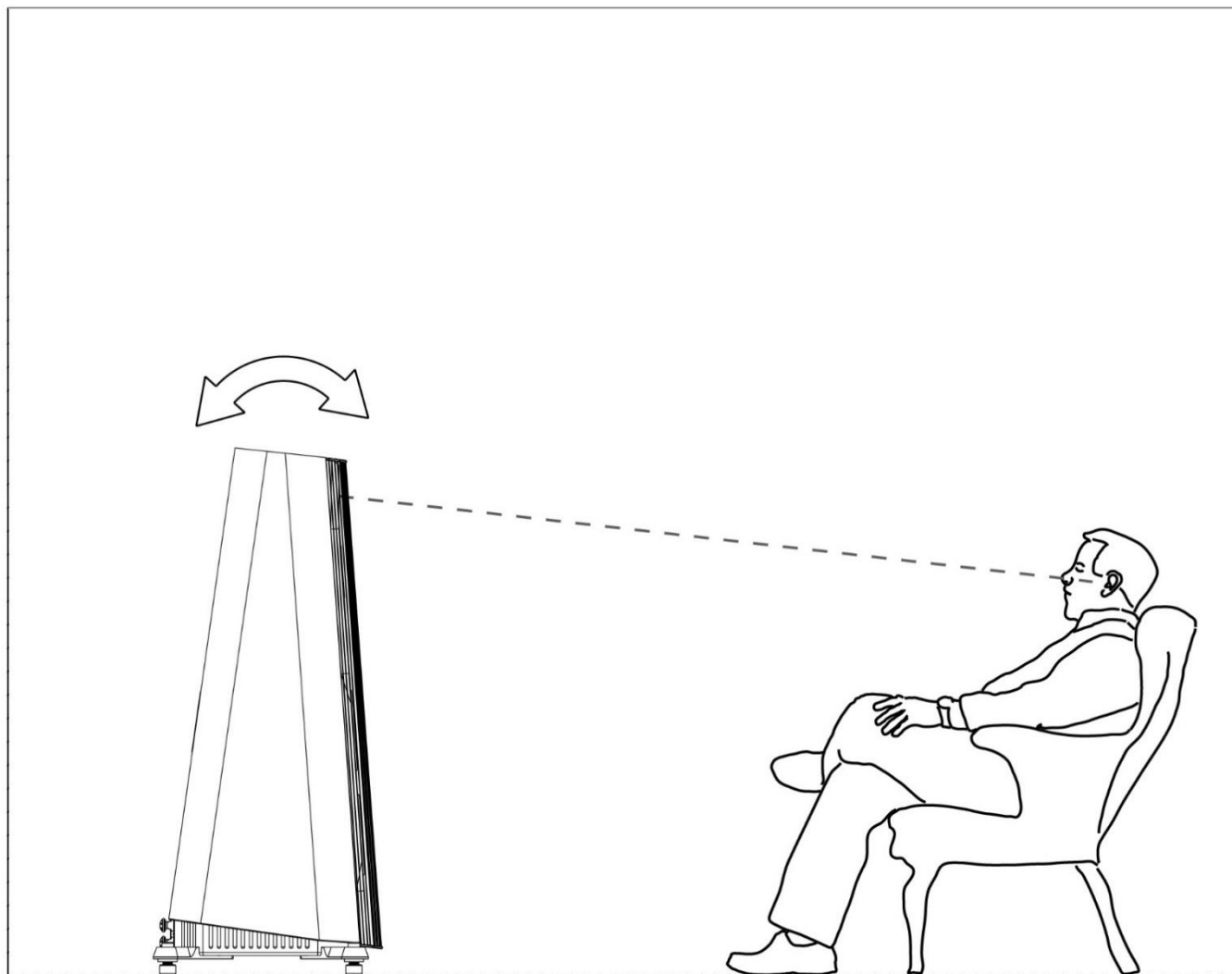

The Threading on each of the four Floor Spikes/Dampers enable the speaker to be adjusted 16 mm (0.63") in height with Spike Dampers fitted and 22 mm (0.87") with Spikes alone.

Pro Tip:

Use Height Adjustment in conjunction with Rake Angle Adjustment to achieve proper waveform arrival at the Ear Level Listening Position.

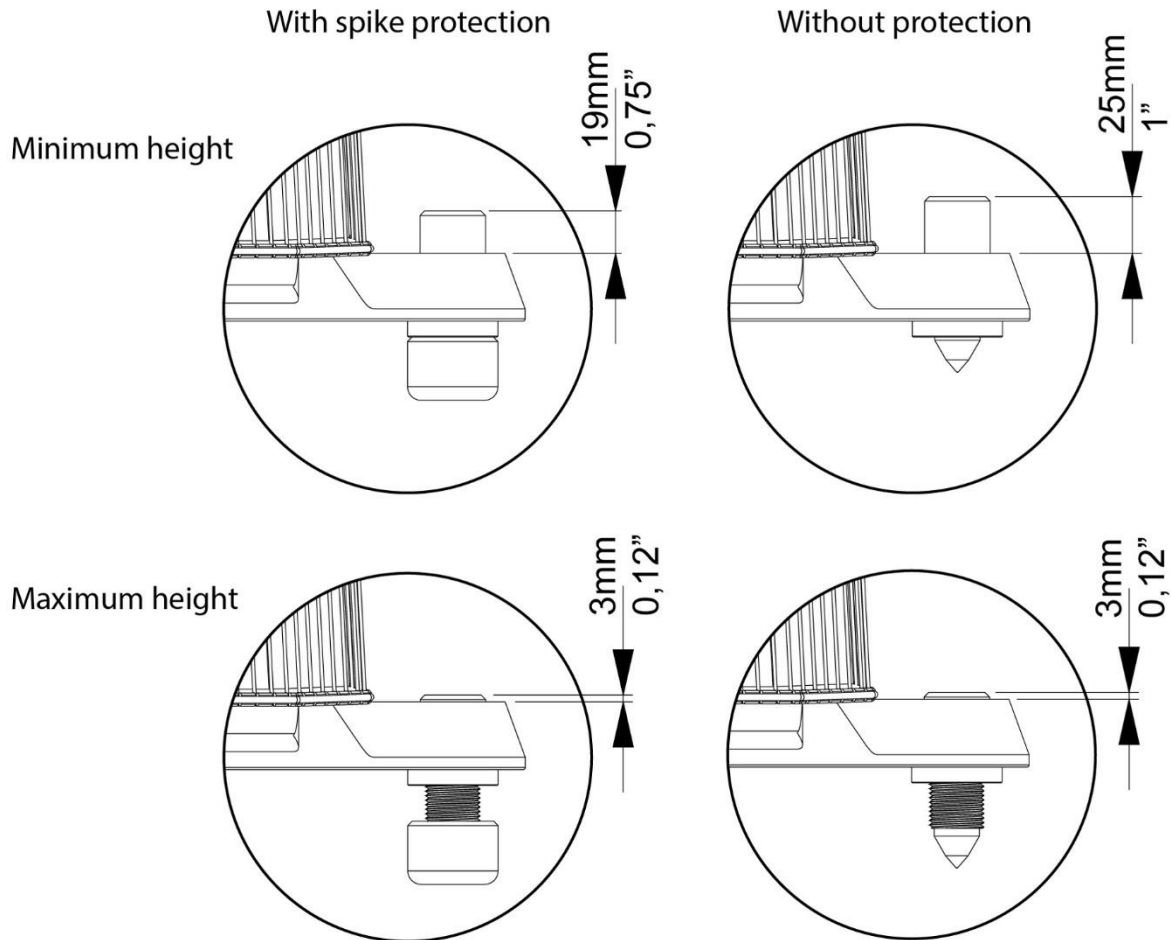

Downloaded from www.linephaze.com

- Find specs, manuals and used listings across thousands of audio products.

Specifications

Type: 3-way, Linear phase, floor stander.

Drivers:

Tweeter: 1 x 1.14" / 29mm, Beryllium Dome, Neodymium Magnet.

Midrange: 1 x 6.5" / 165mm, TPCD™ Cone (With Gryphon proprietary Impulse Optimizer Ring), Neodymium Magnet.

Woofer: 2 x 9.5" / 240mm, TPCD™ Cone (With Gryphon proprietary Impulse Optimizer Ring) Neodymium Magnet.

Principle: Ported. (Line-dampened, Linear Impulse).

Frequency response: 20 - 40.000 Hz (+/-2dB).

Sensitivity: 90dB @2.83V

Impedance: 4 Ω (2.9 Ω min. @ 80Hz).

Crossover: 500 Hz / 2.5 KHz, (2nd order / 4th order, Progressive rising slope).

Bi-wire configuration.

Feet: Adjustable spikes with integrated dampers (Removable).

Dimensions: (H x W x D): 1311 mm x 492 mm x 572 mm (4,3 ft x 1,61 ft x 1,88 ft).

Weight (per speaker): 56,0 Kg (123,5 lb).

Shipping weight (pair of speakers): 195 Kg (429,9 lb).

Above specifications are typical values and subject to changes without prior notice

TPCD™ is a worldwide registered and protected Trademark.



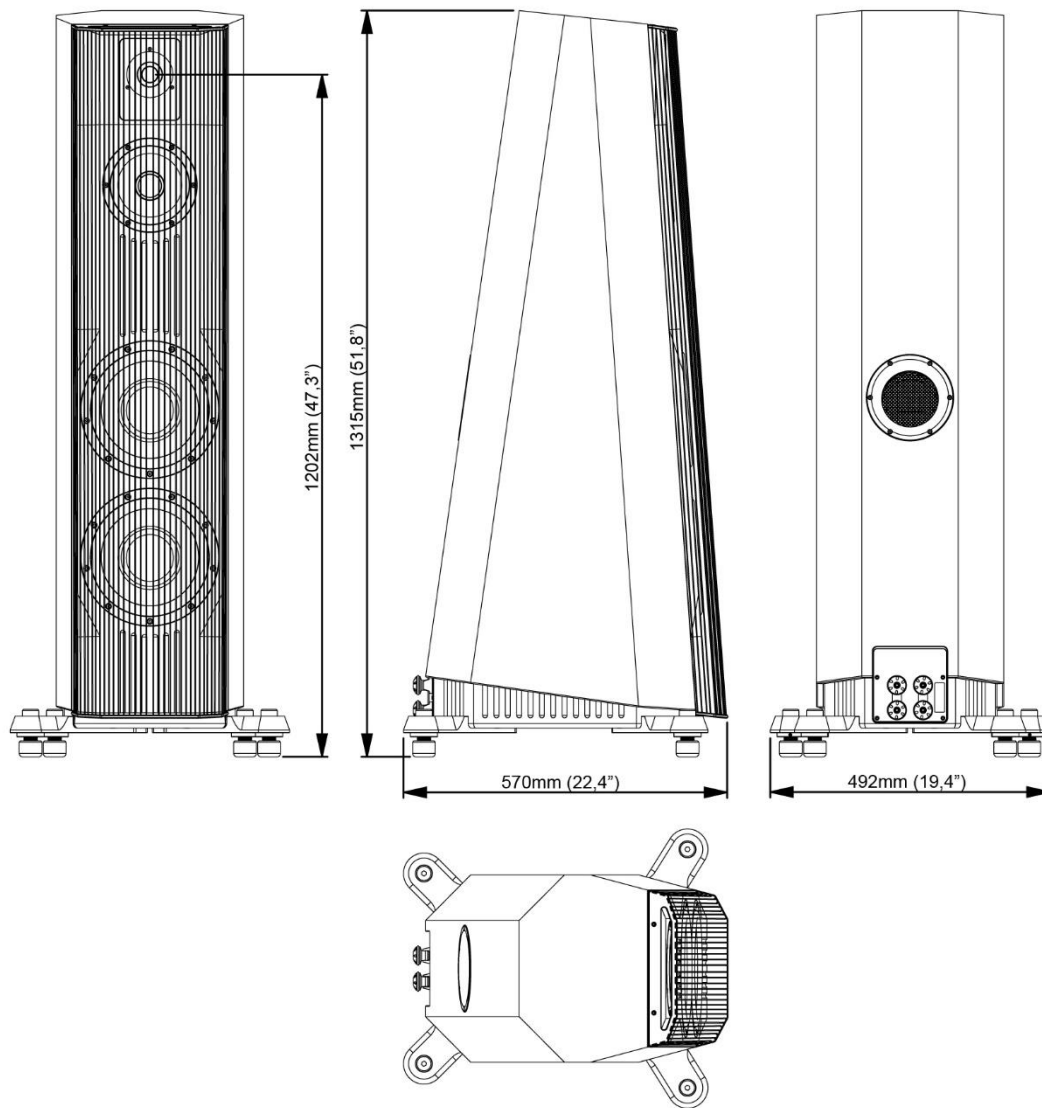

Unpacking

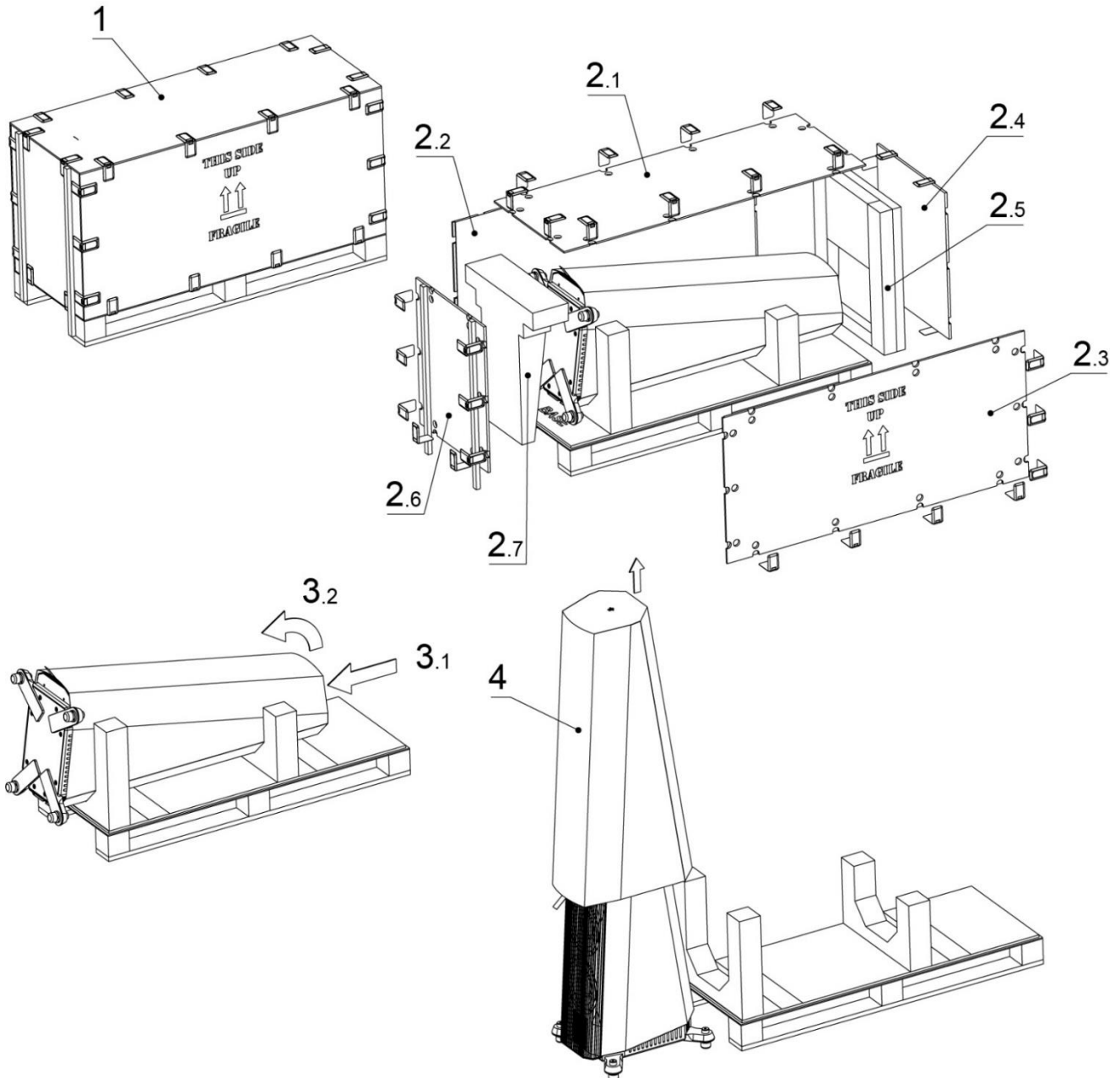



Downloaded from www.linephaze.com

- Find specs, manuals and used listings across thousands of audio products.

Warranty & Support

The Gryphon EOS 5 is warranted against failures arising through faulty workmanship and materials for a period of 3 years from date of purchase. The warranty is not transferable.

This warranty is only valid in the country where the product was purchased.

All claims under this warranty must be made to the distributor in the buyers' country by returning the unit securely packed in the original box with all accessories, postage/freight prepaid and insured. The unit will be repaired or replaced at no charge for parts and labor.

This warranty will be void if the serial number of the unit has been defaced or removed.

No user serviceable parts inside. **This warranty will be void if the unit has been repaired or modified by non-authorized Gryphon dealers or distributors.** Optional modules must be installed by authorized dealers and distributors only.

This warranty does not cover damage due to misuse, accident or neglect.

This warranty is not valid if the operation voltage of the product has been changed.

The distributor or manufacturer, Gryphon Audio Designs, Denmark, retains the exclusive right to make such judgement on the basis of inspection.

The retailer, distributor or manufacturer of the Gryphon shall not be liable for consequential damage arising from the use, misuse or failure of this product, including injuries to persons or property.

Please do not directly contact Gryphon for repair, warranty issues or technical questions. Our local representatives are competent and happy to help you.

To qualify for this warranty; the enclosed warranty registration card must be filled out and returned to Gryphon Audio Designs within 30 days of purchase.

Alternatively, you may wish to register online at www.gryphon-audio.com

Notes	
Gryphon Model:	
Serial No.:	
Date of Purchase:	
Dealer:	
Country:	

Notes

Downloaded from www.linephaze.com

- Find specs, manuals and used listings across thousands of audio products.