

Cayin®

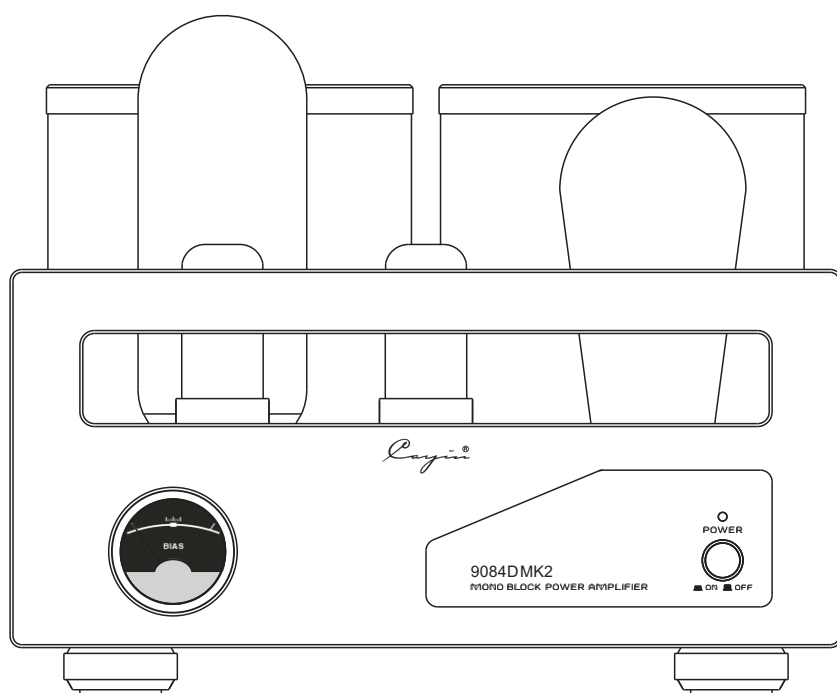

9084D MK2 | MONO BLOCK POWER AMPLIFIER

User's Manual



Thanks for choosing **CAYIN 9084D MK2** Mono Block Power Amplifier and please read the user's manual carefully before installation and operation.

Table of Contents

Table of Contents.....	1
Package Contents.....	2
Product Features.....	3
Safety Precautions.....	3
Specifications.....	4
Maintenance.....	5
Warranty Service.....	5
Precautions.....	6
Front Panel.....	7
Rear Panel.....	8
Top Panel.....	9
Installation.....	10
Tube Replacement	10
Audio Connection.....	11
Turning on.....	12
Small Tips	12
Troubleshooting	13

NOTE:

CAYIN 9084D MK2 Mono Block Power Amplifier is designed and manufactured with our original parts and reaching the best results. We are not responsible for problems and damages caused by non-original parts replacement in the amplifier.

Package Contents

Please carefully check the package first and then open it.

Package contents include:

- | | |
|--------------------|-----------|
| 1. CAYIN 9084D MK2 | 1 piece; |
| 2. Main Fuse | 2 pieces; |
| 3. Power cord | 1 piece; |
| 4. User's Manual | 1 piece; |

Recommendation:

Keep all packing materials for future use .

NOTE:

Please make sure local voltage level is matched with the input level of the amplifier, which indicates on the rear panel. Too low or too high voltage may cause problem. Please contact our company or our local agent if you've found improper voltage.

All other parts except above are not included.



Product Features

- ◆ Hand-made construction with the finest point-to-point wiring.
- ◆ EI output transformer with wide bandwidth are applied.
- ◆ Specially designed toroid transformer for power supply.
- ◆ TUNG-SOL 6SL7 and 6SN7GTB has been used for voltage amplification.
- ◆ Full music 300B together with Shuguang 845 vacuum tube has been used for Single-end Class A amplification.
- ◆ Input stage has taken America rectifier RCA 22DE4 for voltage regulation.
- ◆ External user Bias Adjustment is accessible with the BIAS meter for monitoring on the top of the amplifier.
- ◆ External 845 HUM balance adjustment is accessible.
- ◆ Soft start function (about 30 seconds).
- ◆ Thickly silver-plated signal cable has been used.
- ◆ Equipped with easily-installed tube cover for protection.

Safety precautions

1. Unplug the power cord if you are not going to use the product for an extended period of time.
2. The machine will become hot after working for a long time. Please keep the unit's ventilation open and install the amplifier at a well-ventilated place to avoid troubles and fire hazard.
3. Forbidden to operate when the output is open or shorted.
4. Do not attempt to service this product yourself. Opening the cover may expose you to dangerous voltage or other hazards.
5. We are not responsible for any problems caused by checking and opening without permission of our company. For service, Please contact a qualified service technician.
6. Do not place any objects filled with liquids such as vases or some others on the top or around.
7. Clean only with dry cloth.
8. Please move the amplifier carefully not to drop the unit or be subject to other strong shocks.

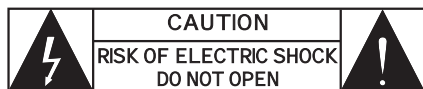

- ◆ To reduce the risk of electric shock, do not remove the cover.
- ◆ No user serviceable parts inside. Refer servicing to qualified service personnel.
- ◆ To reduce the risk of fire or electronic shock, do not expose the unit to rain or moisture.

⚡ The lightning flash with arrowhead symbol is intended to alert user to the presence of uninsulated “dangerous voltage” within the product's enclosure that may be of a risk shock to persons.

! The exclamation point is intended to alert user to the presence of important operation and maintenance (servicing) instructions accompanying the appliance.

Specifications

【Power Output】	28W+28W(8 Ω RMS)	
【Frequency Response】	15Hz~33KHz(-3dB)	
【THD】	2% (1KHz)	
【S/N Ratio】	85dB	
【Input Sensitivity】	1000mV	
【Input Impedance】	100K Ω	
【Output Impedance】	4 Ω , 8 Ω , 16 Ω	
【Max Power Consumption】	200W	
【Tube】	6SL7×1、6SN7×1、300B×1、845×1、22DE4×1	
【WDH】	286×482×239mm³	
【Net Weight】	32.5kg	
【Working Condition】	Temperature 0 °C~40 °C	Moisture 20%~80%
【Storage Condition】	Temperature -20 °C~70 °C	Moisture 20%~90%



Maintenance

NOTE:

- ◆ Use the soft dry cloth to clean up the chassis regularly.
- ◆ Do not use any chemicals for cleaning.

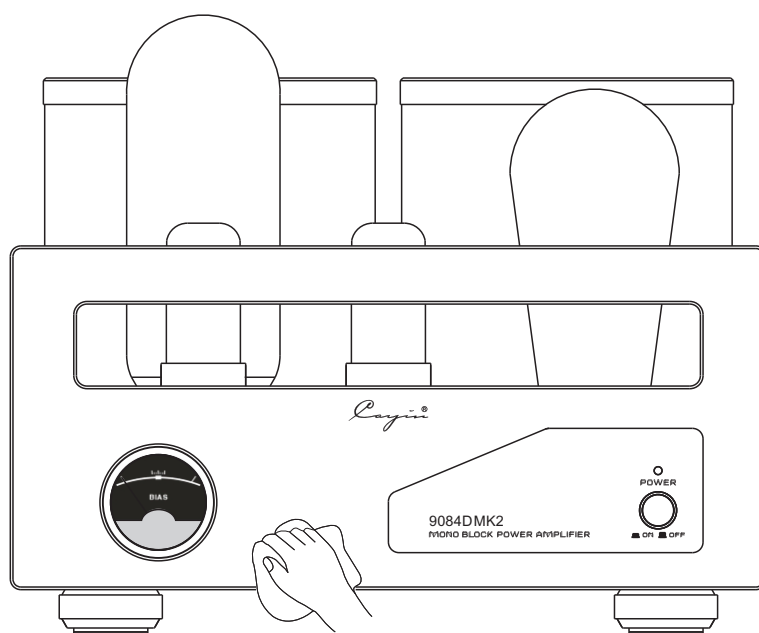

Warranty Service

- 1.This product is warranted for a period of twelve months beginning from the date of purchase.
- 2.The defective product must be returned to your dealer or our company for repairing when your dealer or our company accepts your requirement.
- 3.The warranty doesn't extend to any product that has been opened by you without permission of our company.

NOTE:

The information in this manual is subject to change without further notice.

Precautions

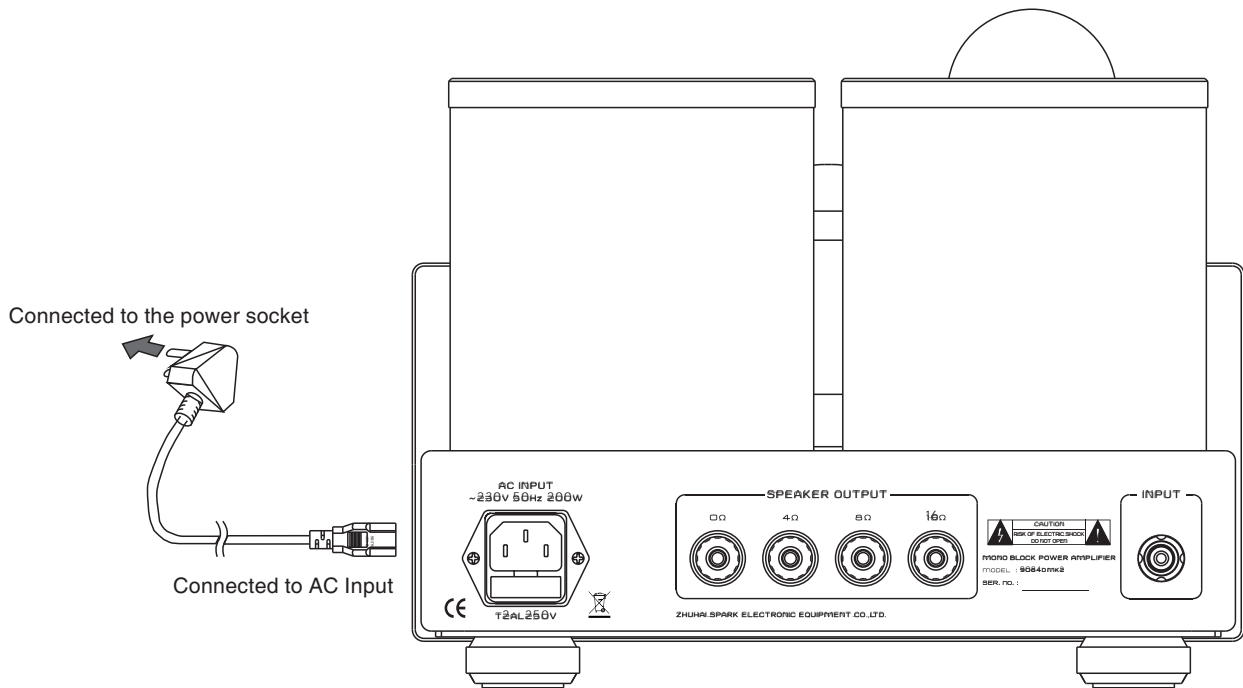

Connection of power cord:

Connect the speaker cables and signal cable first
and then insert the power cord into the power socket.

NOTE:

- ◆ Connect the power only after finishing other connections.
- ◆ It is normal that power transformer becomes hot for extended period of operation.
- ◆ Unplug the power cord if you're not going to use the product for an extended period of time.
- ◆ Please make sure corresponding voltage is the same as required. We are not responsible for damage caused by misuse of unsuitable voltage.



Front Panel

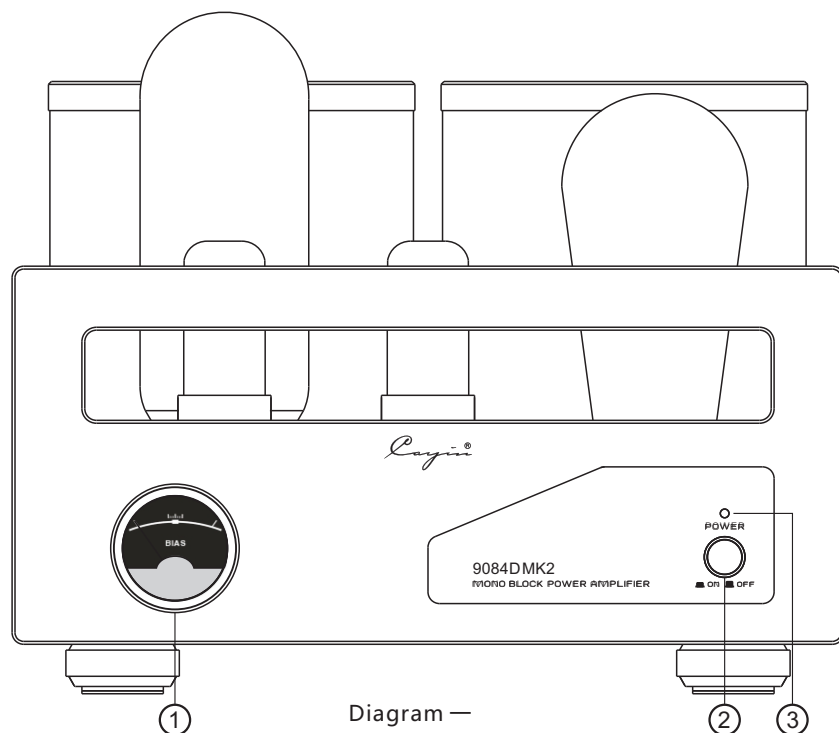

Diagram —

①. Bias Meter

Used to monitor the working current of the power tube.

②. Power Switch:

Used to switch on/off the amplifier.

③. Power indicator

When starting up, the indicator light.



Diagram (—)1
Bias meter when not working



Diagram (—)2
Bias meter during working
Note: When working normally, the pointer should stay within the A zone, still, it would move for the voltage fluctuation.

Rear Panel

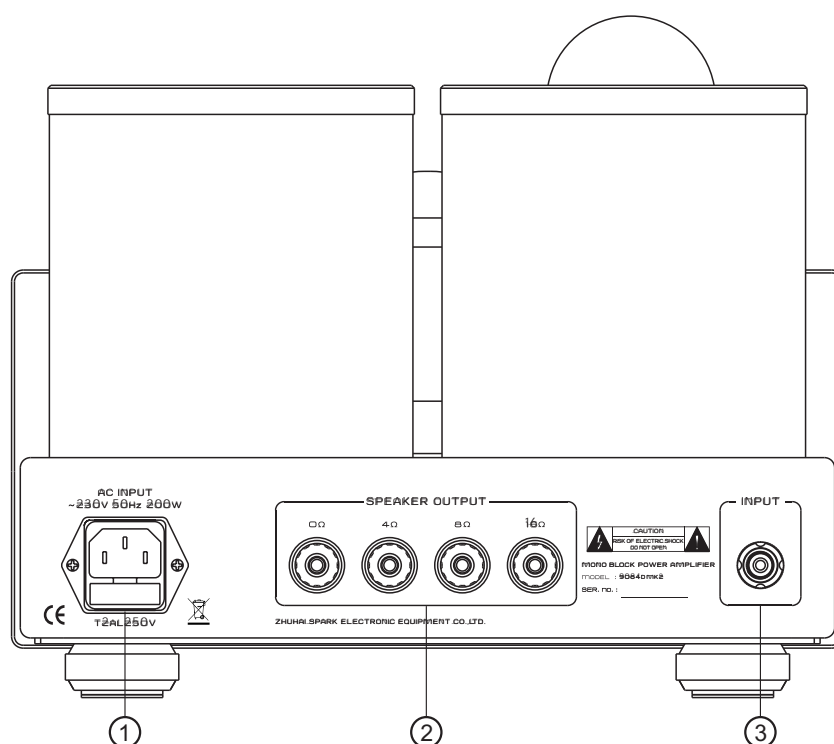

Diagram 二

①. **Power Socket with Main Fuse**

Main fuse is located just below the power socket.

Replace the fuse with the same type as indicated.

②. **Channel Output**

Used to connect with the right channel of speaker.

③. **Signal Input Terminal**

Used for audio source input.

Top Panel

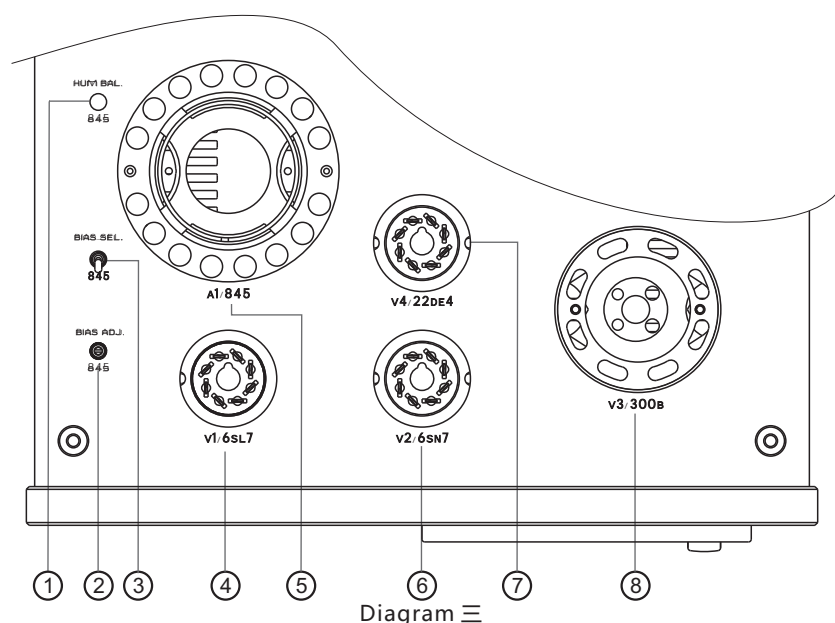

①.HUM Balance (845)

②.Bias Adjustment (845)

Used to adjust bias of corresponding power tube(845)

③.Bias Selector Switch (845)

Used to select corresponding tube for bias adjustment.

④.V1:6SL7 ⑤.A1:845

⑥.V2: 6SN7 ⑦.V4: 22DE4

⑧.V3: 300B

How to adjust the 845 HUM:

Turn the volume knob to the minimum or mute, adjusting the HUM BALANCE with the flat screwdriver, until you hear the smallest HUM.

The same for adjusting the other channel.

Bias adjustment for the power tube:

Turn the Bias Selector Switch to its opposite direction without releasing it, adjust the corresponding Bias Adjustment Switch with flat screwdriver, and inspect the Bias Meter on the top panel to make sure the pointer keeps in the center.

Mount and dismount the 845 vacuum tube:

Clockwise rotation for mounting, and counterclockwise rotation for dismounting.

Mount and dismount the 300B vacuum tube:

The thick pin is for the large hole on the tube socket, and the thin pin is for the small hole on the tube socket. And please insert and extract vertically.

NOTE

- ◆ Be careful of the high temperature of the tubes during operation.
- ◆ Please replace the power tubes after switch off in 20 minutes, and follow the suggestion to unplug the inset the tubes.
- ◆ Power tubes must be matched for well function.
- ◆ Forbidden to make the pointer of the bias meter out of the A zone when adjusting the power tube.
- ◆ Make sure the supply voltage is 230V before bias adjustment.
- ◆ Even under normal working state, the point of the bias meter could move for the voltage fluctuation.



Installation

Carefully read and follow the manual for installation:

- ◆ Do not place the machine near heat sources such as radiators, heat registers or other products that produce heat.
- ◆ In order to avoid being overheated please keep the unit's ventilation open.
- ◆ Do not expose this appliance to rain or moisture.
- ◆ Keep the amplifier in a certain distance so that it can be easily connected.
- ◆ Amplifier should install steadily and make sure all four feet are on the same level.
- ◆ Keep the amplifier over 15cm's distance to the surrounding walls.

NOTE:

Please make sure local voltage level is matched with the input level of the amplifier, which indicates on the rear panel. Too low or too high voltage may cause problems or shorten the amplifier's life.

Tube Replacement

Tubes for the Machine	Tubes Replacement
6SL7	6SL7GT、6H9C、ECC35、6N9P
6SN7	6SN7GT、6H8C、ECC32、6N8P
845	845
300B	300B
22DE4	22DE4

Audio Connection

Connection method of **CAYIN 9084D MK2** with other audio equipments Take pictures below for your reference.

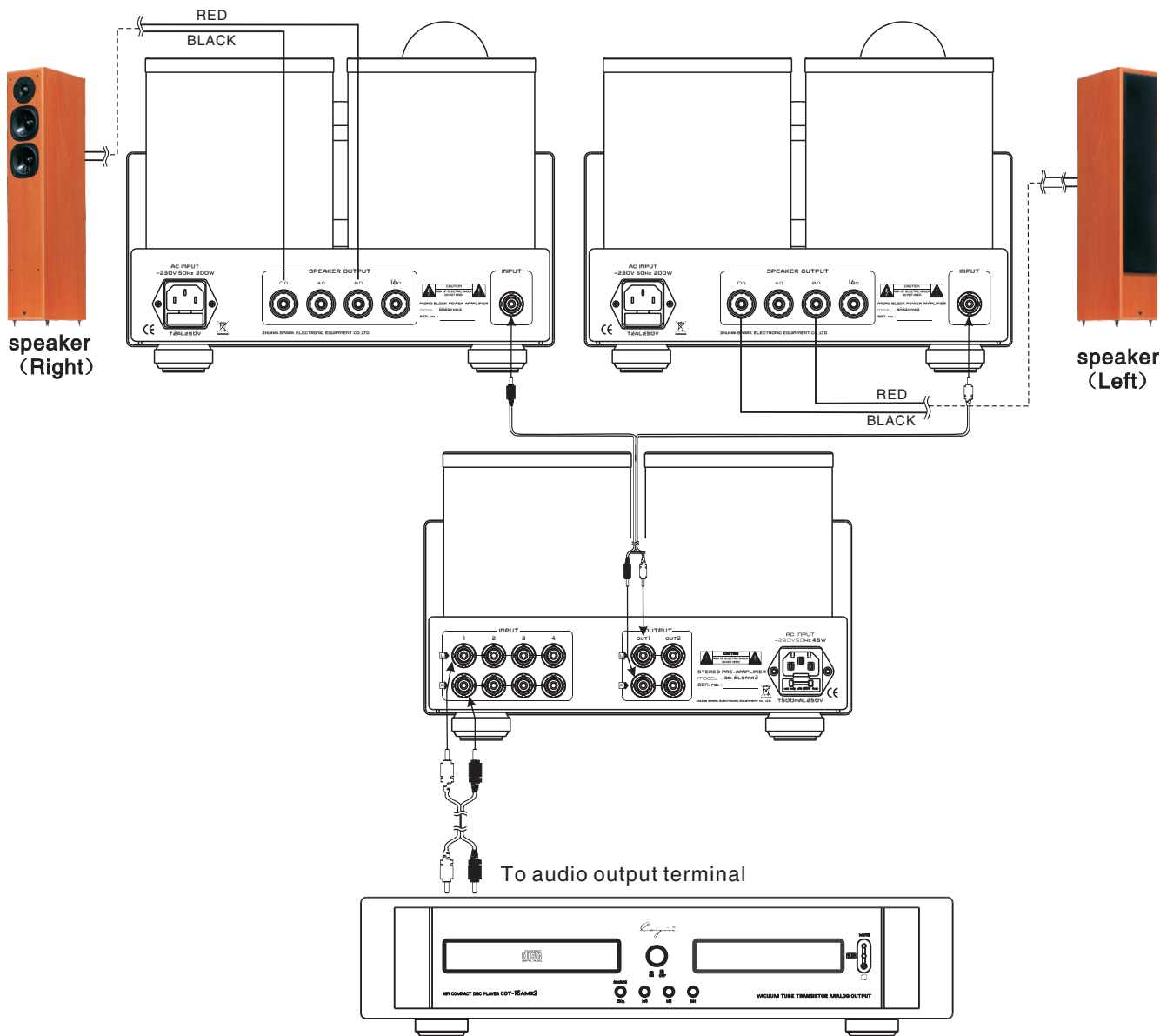

NOTE:

- Please refer to the manuals of other connected equipments during the installation.
- Do not insert the power cord into the main socket before all other equipments are well connected.
- R refers to right channel while L represents left channel.
- Please take the right guidance for connection as wrong connection may cause noise, low-grade function or damage.
- Do not fasten signal cable together with power cable and speaker cables. It will worsen the acoustic fidelity.

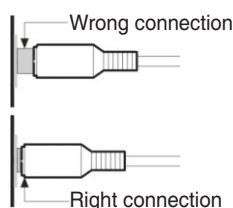

Turning On

Before turning on the amplifier please make sure all connections are right and power supply is stable.

- Turn on the amplifier, the power indicator will be on and the working indicator will keep flickering.
- The working indicator will be on after 30 seconds. It means that the amplifier is working normally. If the working indicator is off, please turn off the power and contact with our local agent or our company.
- Select the right audio source channel, adjust the volume to a certain position and then you can enjoy the music you prefer.

NOTE:

- ◆ Turn on: CD player- decoder- pre-amplifier- power amplifier
- ◆ Turn off: power amplifier- pre-amplifier- decoder- CD player

NOTE:

1. When the audio system is under working state, don't unplug the signal cable or speaker cables, or it will cause damage to the amplifier and other equipments.
2. It should at least takes 2 minutes before you turn on the power again, or it will cause damage to the vacuum tubes.

Small Tips

Read the Manual—— Please read the user's manual carefully before installation and operation.

Keep the Manual——Please keep the manual for future reference.

Warning Signs——Don't tear off or rub off the serial number.

Operation——Do the operations as you are instructed in the Manual.

Parts—— If you are going to use parts not supplied by our company like power cord, fuses etc please make sure that parts you used are compatible with the safety requirements. Or it will cause fire or electric shock.

Placement——Put the amplifier on a level place. Make sure that it doesn't bring damage to the children, adults and the amplifier itself.

Power——Please make sure the local voltage is the same level as indicated on the rear panel.

Overload——If the power socket is overloaded with other equipment, it will cause fire or electric shock.

Warranty Service——Do not open the product and change the components inside yourself. Opening the cover may expose you to dangerous voltage or other hazards. The warranty doesn't extend to any product that has been opened by you without permission of our company.

Troubleshooting——If any problems when you are using the product, please check according to following tips to look for the exact reason. Please contact with our company if you can't solve the problem.



Troubleshooting

Please follow the instruction in the manual in order to keep the amplifier work in its best state. If wrongly operated and you thought that would be troubles please check according to following tip to look for the exact reason.

Problem		Cause	Remedy
NO OUTPUT	Power Indicator is OFF.	Power cord is not well-connected.	Check power cable connection or power outlet connection
		Main fuse is out.	Replace with the same type and value fuse.
	Power Indicator is ON.	NO signal input.	Check the function of the sound source.
			Check the input selection and switch to the proper input.
Noise output		Ground of input signal cable is open or bad contact of the input signal cable.	Replace the input signal cable with a new one.
		Components or circuits are in trouble.	Please contact with local agents or our company.
Sound field Positioning is not so good.		Signal input cables or speaker cables are wrongly connected.	Reconnect it as suggested in the manual.

NOTE: *Cayin®* is the registered trademark of Zhuhai Spark Electronic Equipment Co., Ltd.